

# Fitting guide

To reduce the risk of theft it is essential that your safe is securely fixed. Please use the bolts provided and secure to a solid floor.

For maximum performance and correct installation a professional locksmith must install the safe.

Before operating your new Yale safe, please read the user manual.

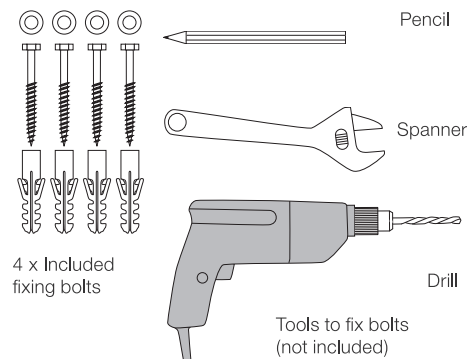

The performance of the safe is dependant on the quality of the installation and the quality of material to which the safe is fixed.

This product is heavy. Incorrect installation may result in injury.

Before fixing the safe please ensure :

- That the safe is placed horizontally.
- That the safe is in a dry environment to prevent corrosion to the safe and locking mechanism.
- That the fixing bolts provided for installation on a solid floor.

1 Mark the position of the safe through fixing holes.

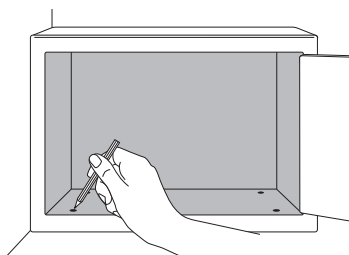

3 Reposition the safe over the holes. Drop the screws and washers through the safe into the drilled holes.

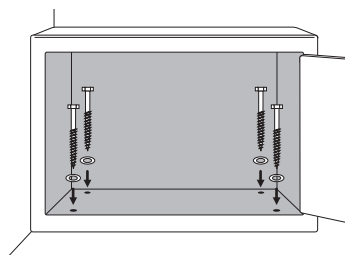

2 Remove the safe and drill the holes as marked. If needed, drop the plugs in the drilled holes.

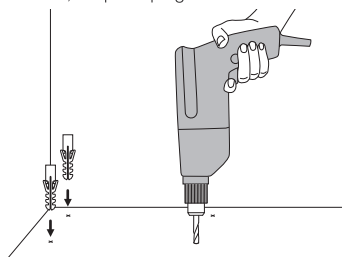

4 Tighten the fixing bolts firmly and ensure there is no movement of the safe.

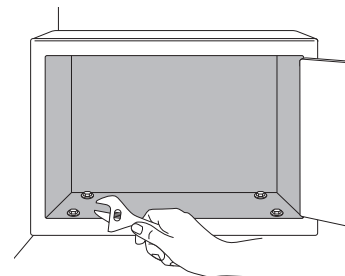

**ASSA ABLOY**  
School Street, Willenhall, West Midlands WV133PW  
Tel: UK: 01902 364606 Tel: ROI: 1890 927622  
www.yale.co.uk



# Treasuring your freedom.

## Yale Safe User Manual

For models:

YSV/200/DB1

YSV/250/DB1

YSV/390/DB1

YLV/200/DB1

Please keep manual safe for future reference.

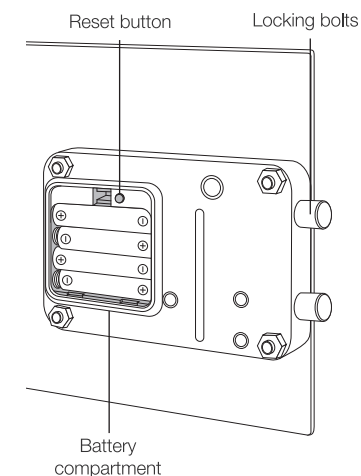
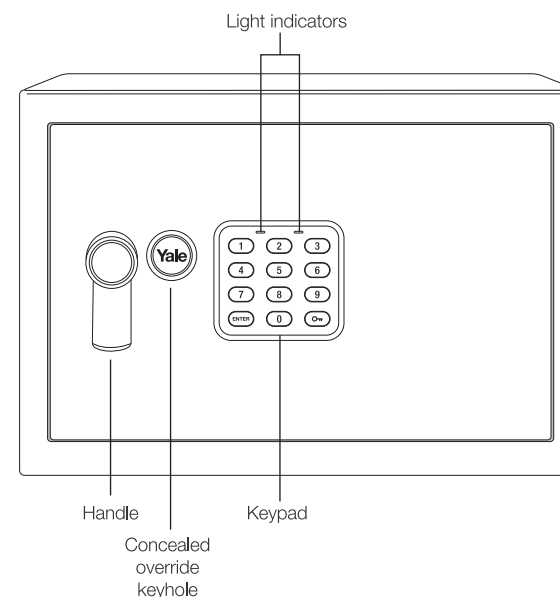

An ASSA ABLOY Group brand **ASSA ABLOY**

The world's favorite lock



## Using the manual override key

1  x 1

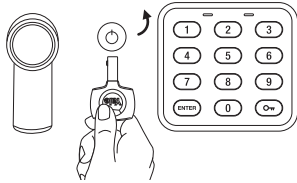

2

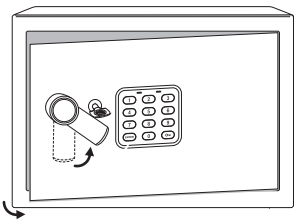

- 1 To open the safe place the key in the key hole behind the Yale logo.
- 2 Turn the key and the handle counterclockwise and open the door.



Please do not store the mechanical override keys inside the safe.



Please note, for security reasons the key can not be removed when the safe is opened using the mechanical override key. To remove the key, you must lock the safe using the key.

## Set/re-set your user code

- 1 Press and hold the red button located on the rear of the door inside the battery compartment until you hear two beeps.

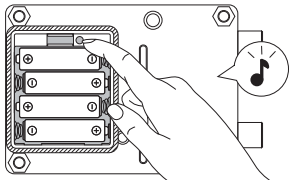

- 2 Enter the code of your choice (between 3-8 digits) then press **ENTER**. When the code is accepted you will hear a confirmation sound and green light will illuminate.

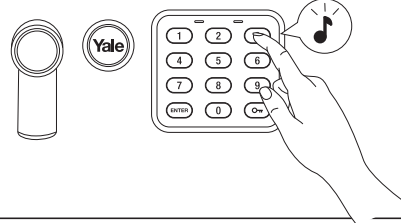

Note : The code needs to be entered within 15 seconds from the red button is pressed. If you fail to do this the red buttons needs to be pressed again.

## Installing/Replacing the batteries

Before using your Yale safe you must insert batteries. The safe requires 4 "AA" (1.5V R06) – batteries.  
When batteries need changing the red light indicator will illuminate when you open the safe using the electronic lock.

1

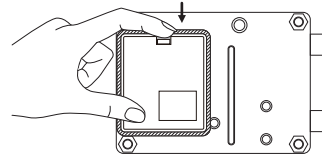

2

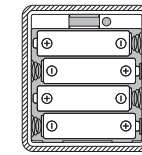

- 1 Remove the battery cover located on the rear of the door.
  - 2 Place the batteries according to the illustration at the back of the battery compartment. Once the batteries are installed, close the battery compartment.
- Note :** If the safe is locked, follow the instructions under "Opening the safe" or "Using the manual override key" to open the safe.



Please note, when new batteries are installed the personal user code is reset and must be re-programmed using the "Set/re-set" your user code.

## Opening the safe

1

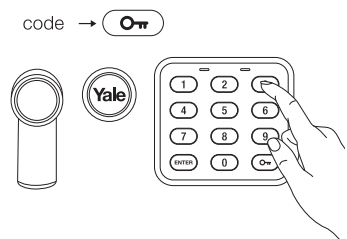

2

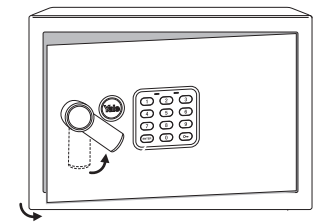

- 1 Enter your user code and press **ENTER**.
- 2 If the code is correct, you will hear a confirmation sound, the green light will illuminate. Turn the handle counterclockwise and open the door.



Please note, if the incorrect user code is entered you will hear a beep. If the wrong user code is entered 3 consecutive times you will not be able to open the safe with the electronic lock for approximately 20 seconds. If the wrong code is entered 6 consecutive times you will not be able to open the safe with the electronic lock for approximately 5 minutes.

## Closing your safe

1

Close the safe door.

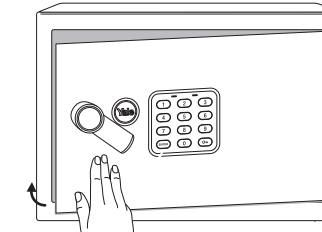

2

Turn the handle clockwise.

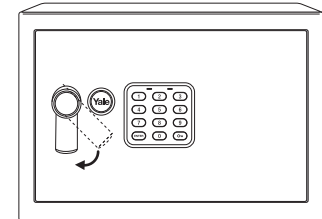

Please note, for security reasons always check that the safes is locked by trying to open the safe again using the handle.