



Vertex Vertical Sliding Window Hardware



Designed for use with
**Imagine Sliding Windows
Collection**



Pages

1-5	Sash lock
6-9	Pole Ring
10-13	Sash Lift
14-16	Tilt Latch Finials (Contemporary and Heritage)
17-20	Travel Restrictor
21-23	Pivot Shoe
24-27	Pivot Bar and Carrier
28-31	Tilt Restrictors
32-33	Sash Spacers
34-37	Tilt Latches

Yale

Vertex™

Sash Lock and Keeps

The Yale Vertex™ range has notably been designed to complement and maintain the traditional aesthetics seen on sash windows, a framework that is most commonly found in British period-style homes.

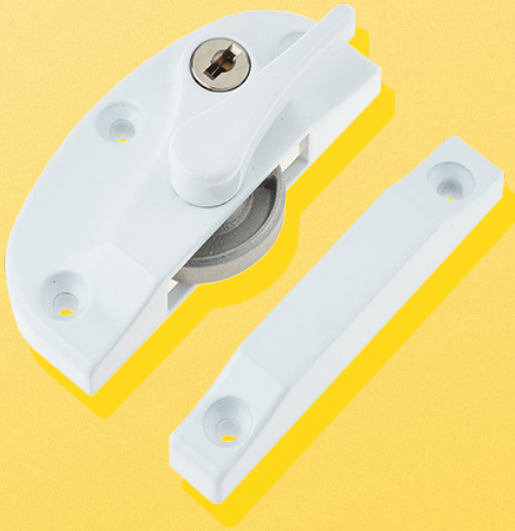

- Contemporary design and simple to operate
- Works with security keeps and decorative security keep cover
- Designed for use on PAS 24 window applications
- Meets the requirements of BS EN 13126-19:2011
- Fitted with Yale lock cylinder
- Supplied with Yale branded key
- Included within the Yale Lifetime Security Guarantee
- Available in a range of finishes

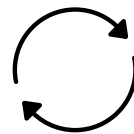

Cycle Tested to BS 6375:
Part 2 (20,000 cycles)

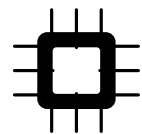

Cross Hatch
Adhesion Tested

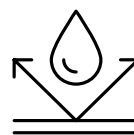

BS EN 1670: Grade 4
240 Hours NSST

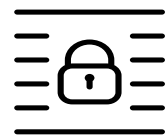

PAS24

Designed to achieve the
requirements of PAS24
when fitted with Yale's
complete Vertex hardware

**10
YEAR**
SURFACE FINISH
GUARANTEE

**10
YEAR**
MANUFACTURERS
GUARANTEE

Part codes

Product	Part code
Sash Lock	
Sash Lock - Chrome	YVSSF01-CH
Sash Lock - Champagne Gold	YVSSF01-CG
Sash Lock - Silver	YVSSF01-SL
Sash Lock - White	YVSSF01-WH
Sash Lock - Satin Black	YVSSF01-SB
Sash Lock - Bronze	YVSSF01-BRZ
Sash Lock - Satin Chrome	YVSSF01-SC
Sash Lock - Anthracite Grey	YVSSF01-AG
Sash Lock - Gold	YVSSF01-GO
Sash Lock - Brushed Stainless Finish	YVSSF01-BSF
Security Keep	
Pressed Keep (short) - Chrome	YVSPK02-01-CH
Pressed Keep (short) - Champagne Gold	YVSPK02-01-CG
Pressed Keep (short) - Silver	YVSPK02-01-SL
Pressed Keep (short)- White	YVSPK02-01-WH
Pressed Keep (short) - Satin Black	YVSPK02-01-SB
Pressed Keep (short) - Bronze	YVSPK02-01-BRZ
Pressed Keep (short) - Satin Chrome	YVSPK02-01-SC
Pressed Keep (short) - Anthracite Grey	YVSPK02-01-AG
Pressed Keep (short) - Gold	YVSPK02-01-GO
Pressed Keep (short) - Brushed Stainless Finish	YVSPK02-01-BSF

Part codes

Product	Part code
Keep Cover	
Keep Cover - Chrome	YVSKC01-CH
Keep Cover - Champagne Gold	YVSKC01-CG
Keep Cover - Silver	YVSKC01-SL
Keep Cover - White	YVSKC01-WH
Keep Cover - Satin Black	YVSKC01-SB
Keep Cover - Bronze	YVSKC01-BRZ
Keep Cover - Satin Chrome	YVSKC01-SC
Keep Cover - Anthracite Grey	YVSKC01-AG
Keep Cover - Gold	YVSKC01-GO
Keep Cover - Brushed Stainless Finish	YVSKC01-BSF



Designed for uPVC,
Aluminum and Timber
vertical sliding sash
windows

Sash Lock

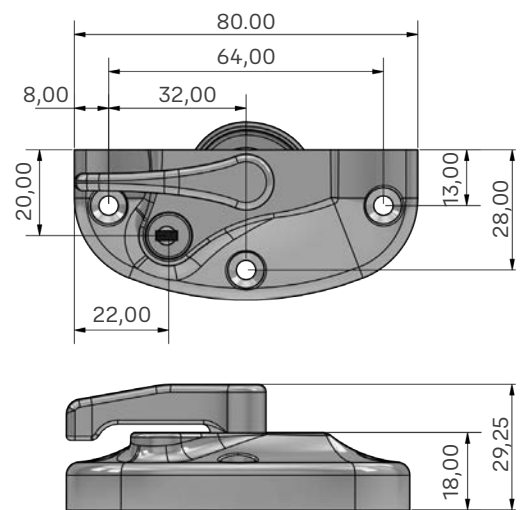
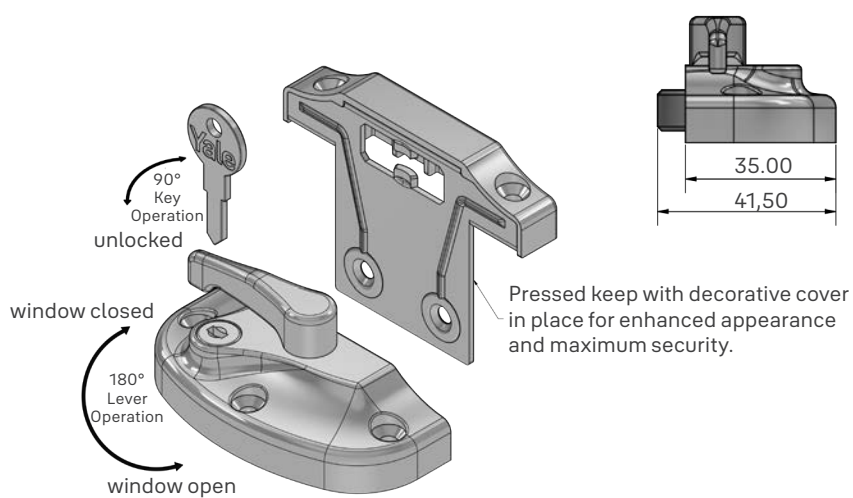

Security keep

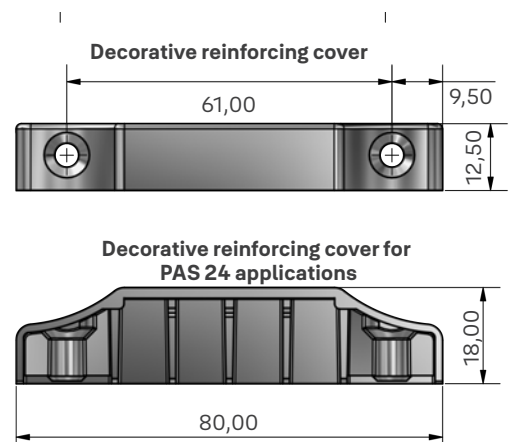
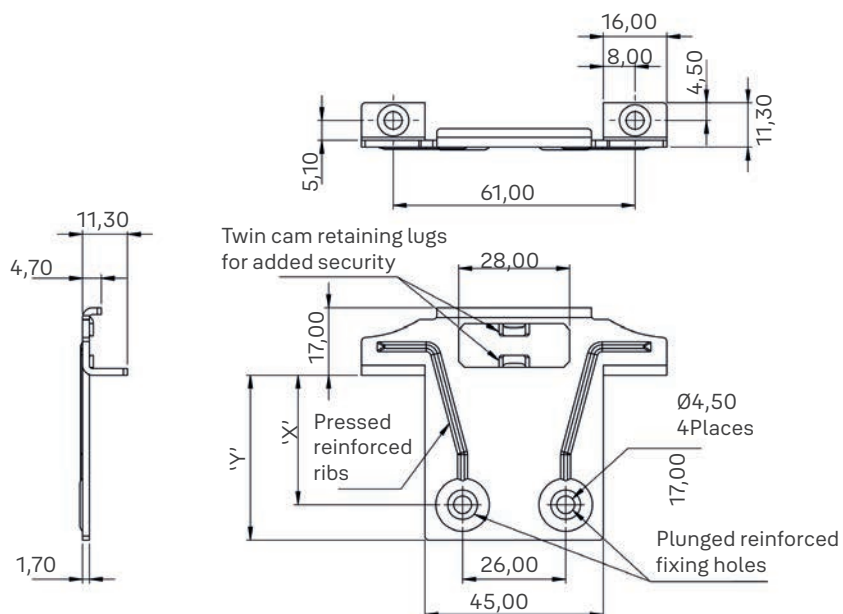

Pressed keep	Dim 'X'	Dim 'Y'
YVSPK02-01	33.0	42.0

Cross-section for the keep, keep cover, and sash lock

Ø4.2 self tapping screws ensuring full engagement into profile reinforcement whenever possible

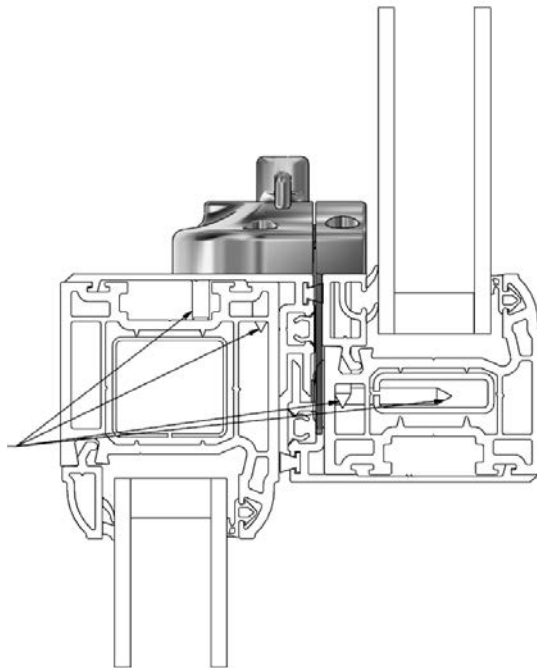

Maintenance

Yale recommends this product is surface cleaned with a damp cloth only and is kept free from any building materials and debris which could affect the mechanism.

Colour Variants

White
Satin Black
Chrome
Champagne Gold
Silver
Anthracite Grey
Brushed Stainless Finish
Bronze
Satin Chrome

Material Specification

Sash locks - Boxed in 100's
Pressed keeps - Boxed in 100's
Decorative reinforcing covers -
Boxed in 100's

Packaging

Die-cast Zinc
Reinforced Nylon
Carbon Steel
Pressed Keep - 304 Stainless
Steel



Vertex™

Pole Ring

The Yale Vertex™ range has notably been designed to complement and maintain the traditional aesthetics seen on sash windows, a framework that is most commonly found in British period-style homes

- Designed for appearance and functionality
- Available in a range of finishes
- Manufactured in high performance die-cast zinc
- Included within the Yale Lifetime Security Guarantee

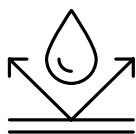

BS EN 1670: Grade 4
240 Hours NSST

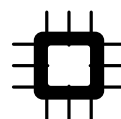

Cross Hatch Adhesion
Tested





Product	Part code
Pole Ring - Chrome	YVSPR01-CH
Pole Ring - Champagne gold	YVSPR01-CG
Pole Ring - Silver	YVSPR01-SL
Pole Ring - White	YVSPR01-WH
Pole Ring - Satin Black	YVSPR01-SB
Pole Ring - Anthracite Grey	YVSPR01-AG
Pole Ring - Brushed Stainless Finish	YVSPR01-BSF
Pole Ring - Satin Chrome	YVSPR01-SC
Pole ring - Bronze	YVSPR01-BRZ



Designed for uPVC,
Timber and Aluminium
vertical sliding sash
windows

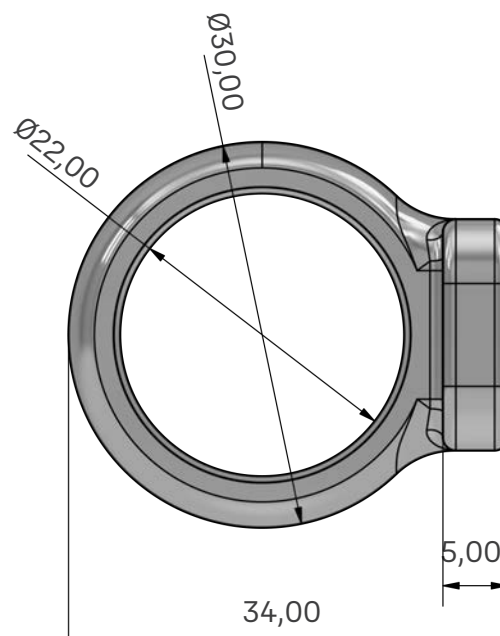
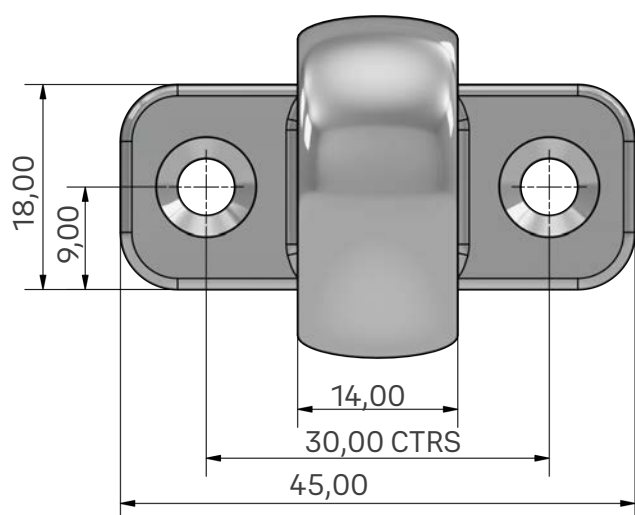

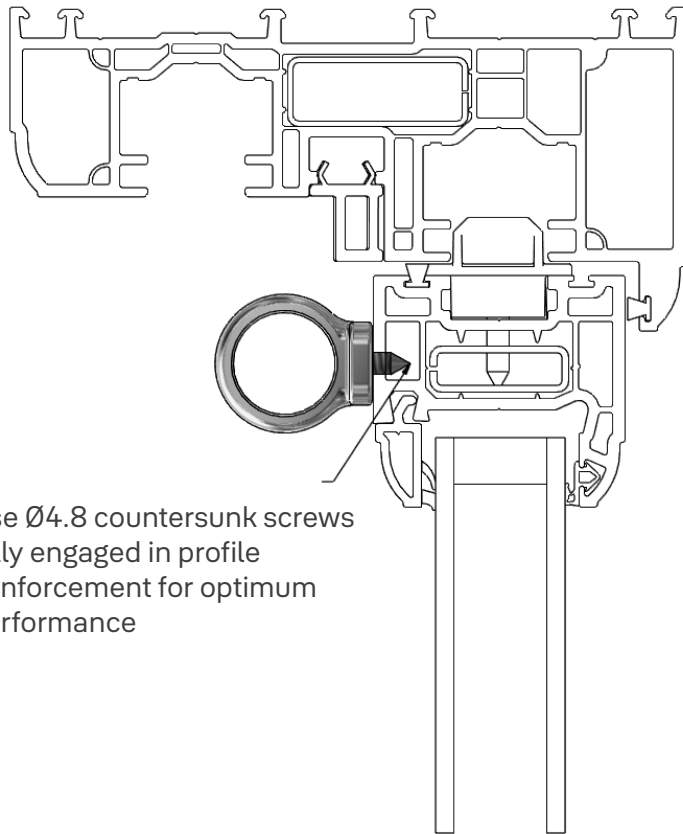

Cross-section for Pole Ring

Use Ø4.8 countersunk screws fully engaged in profile reinforcement for optimum performance

Maintenance

Yale recommends this product is surface cleaned with a damp cloth only and is kept free from any building materials and debris which could affect the mechanism.

Colour Variants

White
Satin Black
Chrome
Champagne gold
Silver
Anthracite Grey
Brushed Stainless Finish
Bronze
Satin Chrome

Packaging

Boxed in 100's

Material Specification

Die-cast Zinc



Vertex™

Sash Lift

The Yale Vertex™ range has notably been designed to complement and maintain the traditional aesthetics seen on sash windows, a framework that is most commonly found in British period-style homes



- Suitable for use on all vertical sliding windows
- Designed for appearance and functionality
- Die -cast zinc for consistent hole positions
- Available in a range of finishes
- Included within the Yale Lifetime Security Guarantee

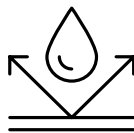

BS EN 1670: Grade 4
240 Hours NSST

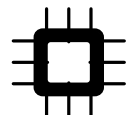

Cross Hatch Adhesion
Tested





Product	Part code
Sash Lift - Chrome	YVSSL01-CH
Sash Lift - Champagne gold	YVSSL01-CG
Sash Lift - Silver	YVSSL01-SL
Sash Lift - White	YVSSL01-WH
Sash Lift - Black	YVSSL01-SB
Sash Lift - Anthracite Grey	YVSSL01-AG
Sash Lift - Brushed Stainless Finish	YVSSL01-BSF
Sash Lift - Satin Chrome	YVSSL01-SC
Sash Lift - Bronze	YVSS01-BRZ



Designed for
uPVC, Timber and
Aluminium vertical
sliding sash windows

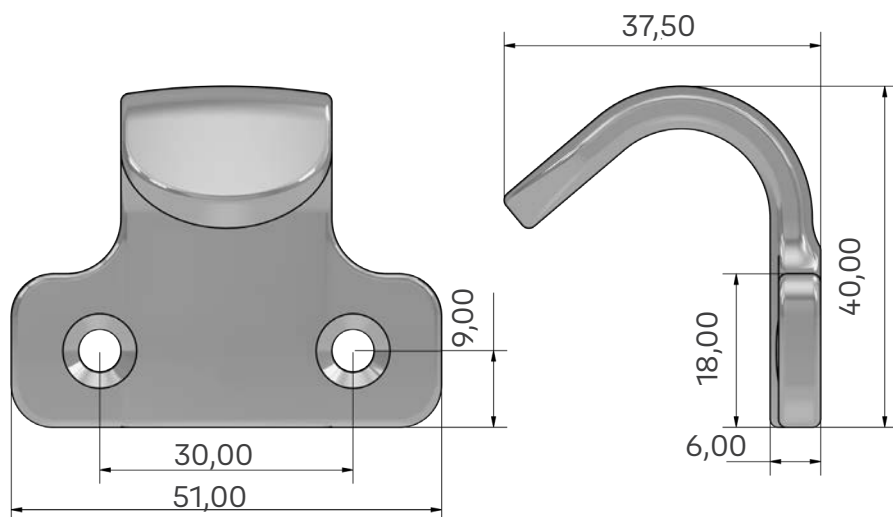

Cross-section for Sash Lift

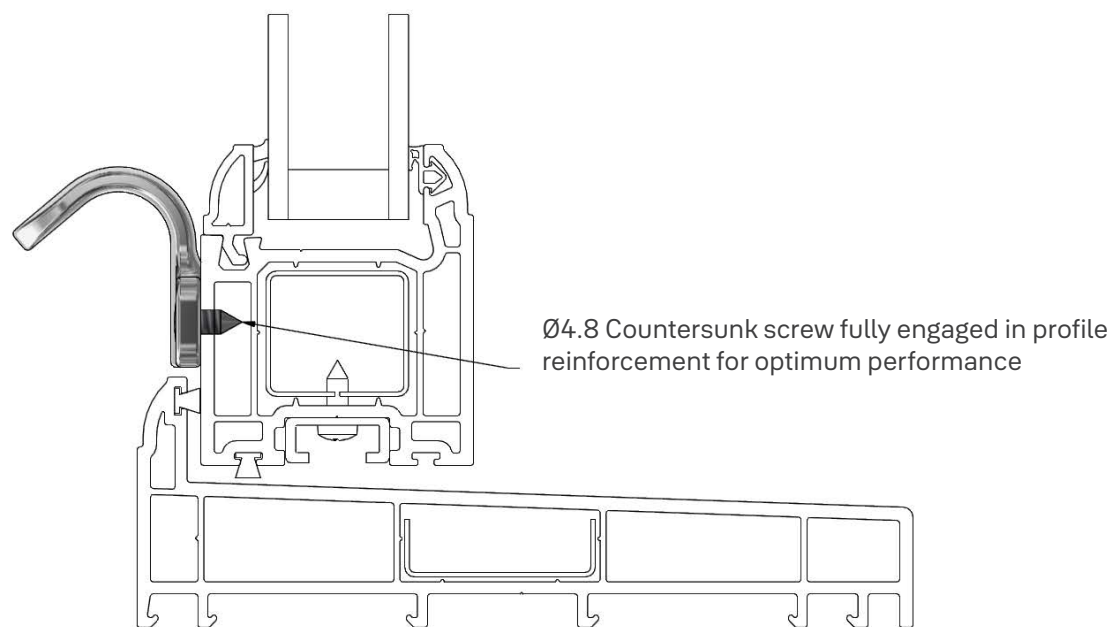

Maintenance

Yale recommends this product is surface cleaned with a damp cloth only and is kept free from any building materials and debris which could affect the mechanism.

Colour Variants

- White
- Satin Black
- Chrome
- Champagne gold
- Silver
- Anthracite grey
- Brushed Stainless finish
- Bronze
- Satin Chrome

Packaging

Boxed in 100's

Material Specification

Die-cast Zinc



Vertex™

Tilt Latch Finials

The Yale Vertex™ range has notably been designed to complement and maintain the traditional aesthetics seen on sash windows, a framework that is most commonly found in British period-style homes



Heritage Tilt Latch Finial



Contemporary Tilt Latch Finial

- Suitable for use on all vertical sliding windows
- Designed for appearance and function
- Die -cast zinc for consistent hole positions
- Available in a range of finishes
- Included within the Yale Lifetime Security Guarantee

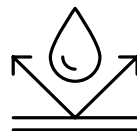

BS EN 1670: Grade 4
240 Hours NSST

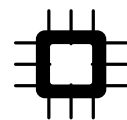

Cross Hatch Adhesion
Tested

**10
YEAR**
SURFACE FINISH
GUARANTEE



Product	Part code
Contemporary Tilt Latch Finial - Chrome	YVSKD01-CH
Contemporary Tilt Latch Finial - Champagne Gold	YVSKD01-CG
Contemporary Tilt Latch Finial - Silver	YVSKD01-SL
Contemporary Tilt Latch Finial - White	YVSKD01-WH
Contemporary Tilt Latch Finial - Satin Black	YVSKD01-SB
Contemporary Tilt Latch Finial - Anthracite Grey	YVSKD01-AG
Contemporary Tilt Latch Finial - Brushed Stainless Finish	YVSKD01-BSF
Contemporary Tilt Latch Finial - Satin Chrome	YVSKD01-SC
Contemporary Tilt Latch Finial - Bronze	YVSKD01-BRZ
Heritage Tilt Latch Finial - Chrome	YVSKD02-CH
Heritage Tilt Latch Finial - Champagne Gold	YVSKD02-CG
Heritage Tilt Latch Finial - Silver	YVSKD02- SL
Heritage Tilt Latch Finial - White	YVSKD02-WH
Heritage Tilt Latch Finial - Satin Black	YVSKD02-SB
Heritage Tilt Latch Finial - Anthracite Grey	YVSKD02-AG
Heritage Tilt Latch Finial - Brushed Stainless Finish	YVSKD02-BSF
Heritage Tilt Latch Finial - Satin Chrome	YVSKD02-SC
Heritage Tilt Latch Finial - Bronze	YVSKD02-BRZ
Non-decorative Upper Sash Tilt Finial - Silver Anodised	YVSKND01

Maintenance

Yale recommends this product is surface cleaned with a damp cloth only and is kept free from any building materials and debris which could affect the mechanism.



Cross-section

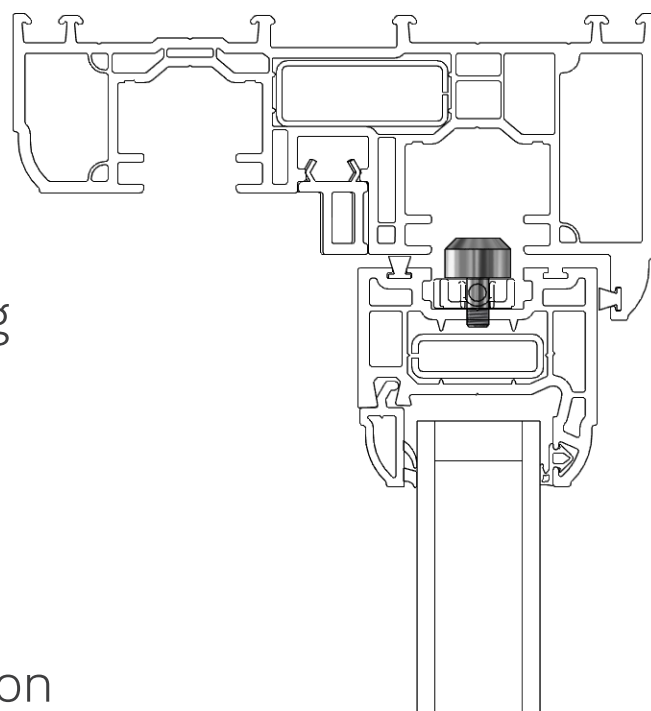
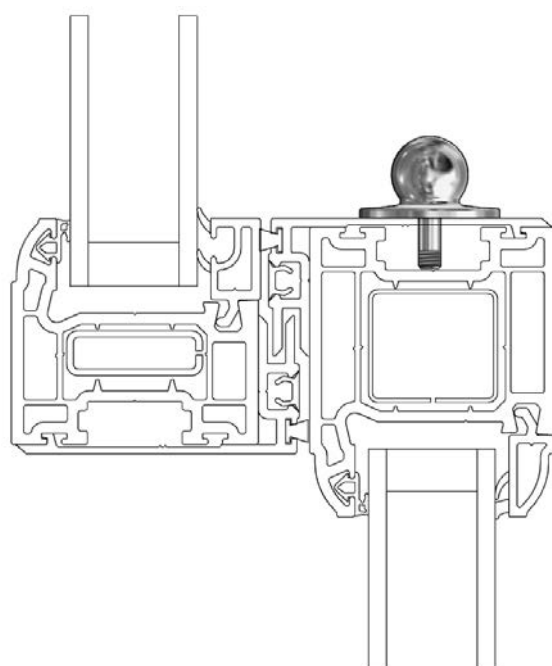
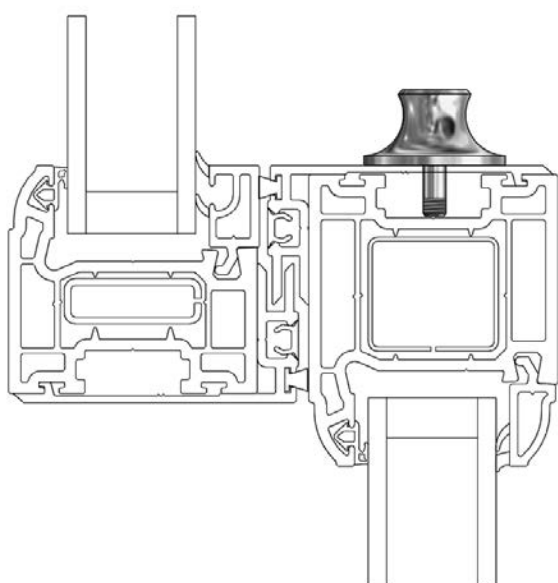

Colour Variants

White
Satin Black
Chrome
Champagne gold
Silver
Anthracite Grey
Brushed Stainless Finish
Bronze
Satin Chrome

Packaging

Boxed in 100's

Material Specification

Zinc die-cast

Yale



Vertex™

Travel Restrictors

The Yale Vertex™ range has notably been designed to complement and maintain the traditional aesthetics seen on sash windows, a framework that is most commonly found in British period-style homes

- Designed to be functional and simple to operate
- Offers optimum safety providing peace of mind
- Manufactured from high quality materials
- Key supplied with every restrictor
- Meets the requirements of BS EN 1670 2007
- Included in Yale Lifetime Security Guarantee
- Available in a range of colours

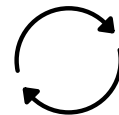

Cycle Tested to BS 6375:
Part 2 (20,000 cycles)

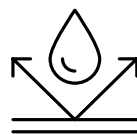

BS EN 1670: Grade 4
240 Hours NSST

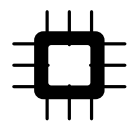

Cross Hatch Adhesion
Tested

**10
YEAR**

**SURFACE FINISH
GUARANTEE**

**10
YEAR**

**MANUFACTURERS
GUARANTEE**



Product	Part code
Travel Restrictor - Chrome	YVSTR01-CH
Travel Restrictor - Champagne Gold	YVSTLR01-GB
Travel Restrictor - Silver	YVSTLR01-SL
Travel Restrictor - White	YVSTLR01-WH
Travel Restrictor - Black	YVSTLR01-SB
Travel Restrictor - Anthracite Grey	YVSTLR01-AG
Travel Restrictor - Brushed Stainless Finish	YVSTLR01-BSF
Travel Restrictor - Satin Chrome	YVSTLR01-SC
Travel Restrictor - Bronze	YVSTLR01-BRZ

Maintenance

Yale recommends this product is surface cleaned with a damp cloth only and is kept free from any building materials and debris which could affect the mechanism.



The Vertex Travel Restrictor enables the user to restrict the travel of both window sashes typically to a maximum of 100mm

Key operated enabling a spring loaded tongue to open out and be easily returned and retained ensuring that the restrictor cannot be easily by passed by anyone other than the key holder

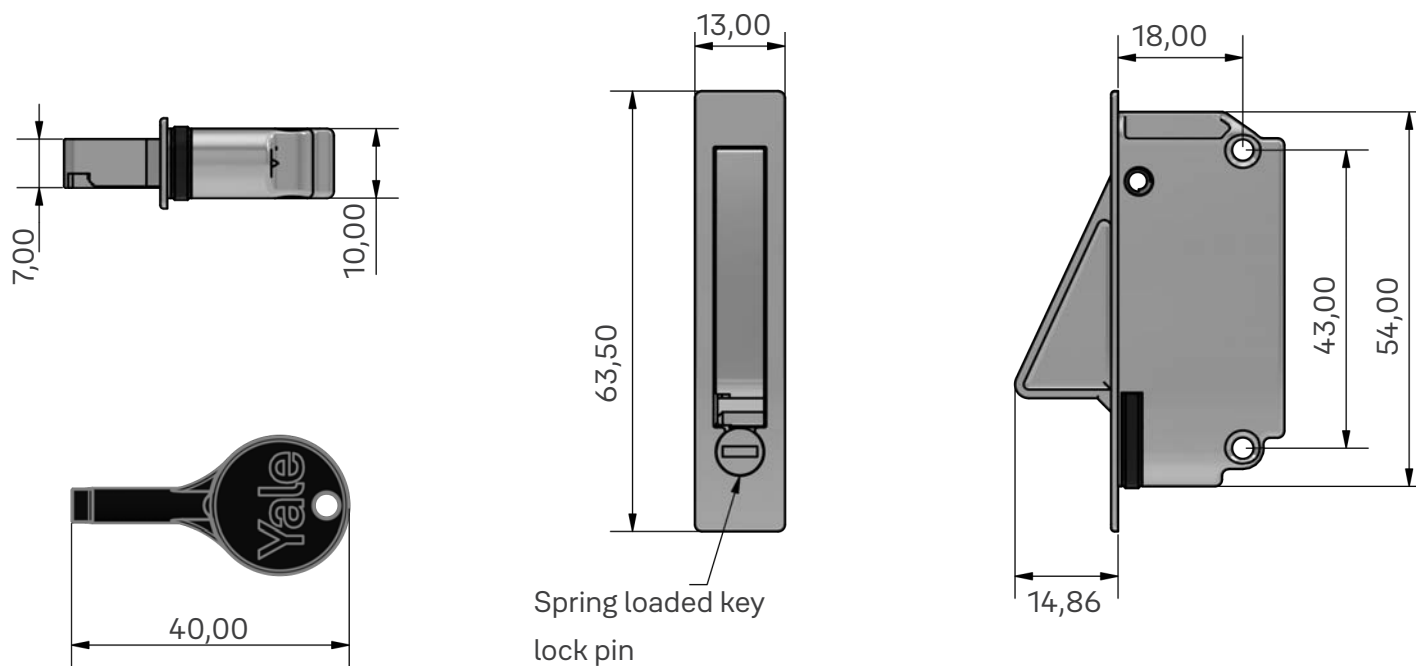

Operation

Using the key provided rotate the locking pin anti-clockwise to release the restrictor tongue. Remove the key and the restrictor tongue will lock in the restricted operation mode. To enable full movement of the window rotate the key lock anti-clockwise, again using the key, push the restrictor tongue fully into the restrictor body and release the key.

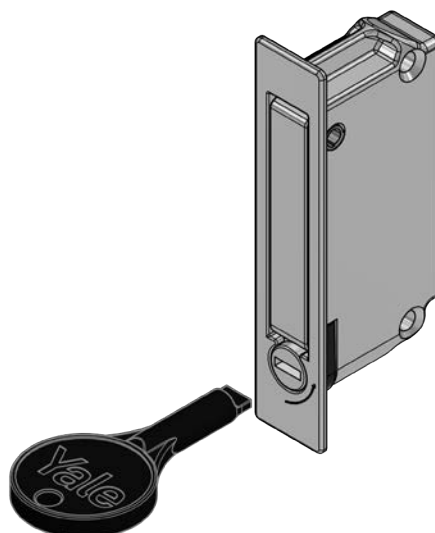

The Vertex Travel Restrictor is inserted into the pre-machined slot in the upper sash slide rails.

It is then retained via two M3 grub screws (not included) to ensure a secure location in the frame.

Please ensure the screw length used engages fully into the restrictor body and does not inhibit the sash from sliding or tilting correctly.

Note: On slimline sash profiles the bead clip may need notching to provide clearance for the restrictor body

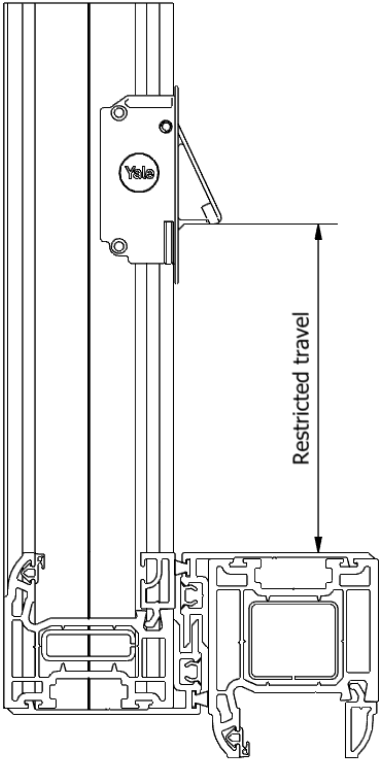
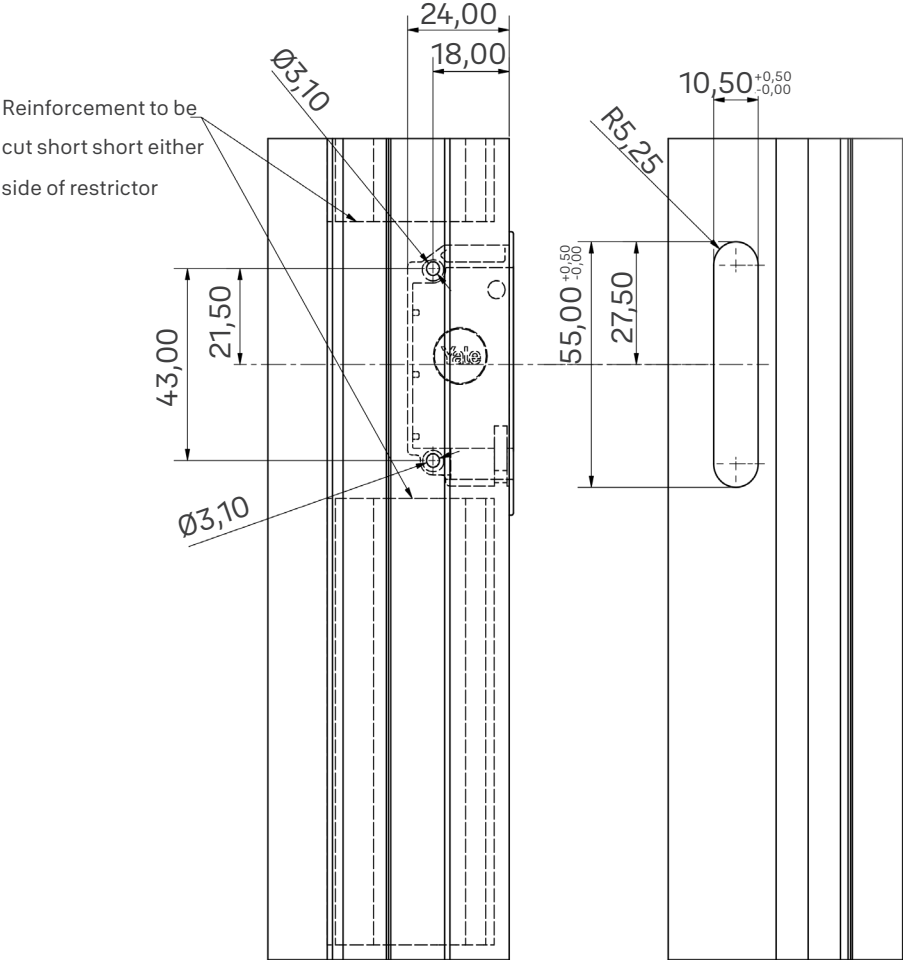

It is strongly recommended that two restrictors are fitted to windows of any size. One restrictor on each side of the sash provides the best possible travel restriction.

Colour Variants

- White
- Satin Black
- Chrome
- Champagne gold
- Silver
- Anthracite grey
- Brushed Stainless finish
- Bronze
- Satin Chrome

Packaging

- Boxed in 100's
- 1 key provided per Travel Restrictor

Material Specification

- Die-cast Zinc
- Reinforced Nylon
- High performance Spring Steel

The Yale logo, consisting of the word "Yale" in a bold, black, sans-serif font, is centered within a bright yellow circle.

Vertex™

Pivot Shoe

A high performance pivot shoe with enhanced braking functionality



- Suitable for both 'lift-off' and 'slide-off' applications
- Included within the Yale Lifetime Security Guarantee
- Tested to 20,000 cycles
- Patent pending

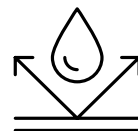

BS EN 1670: Grade 4
240 Hours NSST

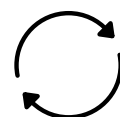

Cycle Tested to BS 6375:
Part 2 (20,000 cycles)

**10
YEAR**
**MANUFACTURERS
GUARANTEE**



Product	Profile Sytem	Part code
Pivot Shoe	VEKA	YVSPS155

Tool Option	Part code
Balancing Tensioning Tool	YVSTEN

Maintenance	Yale recommends this product is surface cleaned with a damp cloth only and is kept free from any building materials and debris which could affect the mechanism.
--------------------	------------------------------------------------------------------------------------------------------------------------------------------------------------------

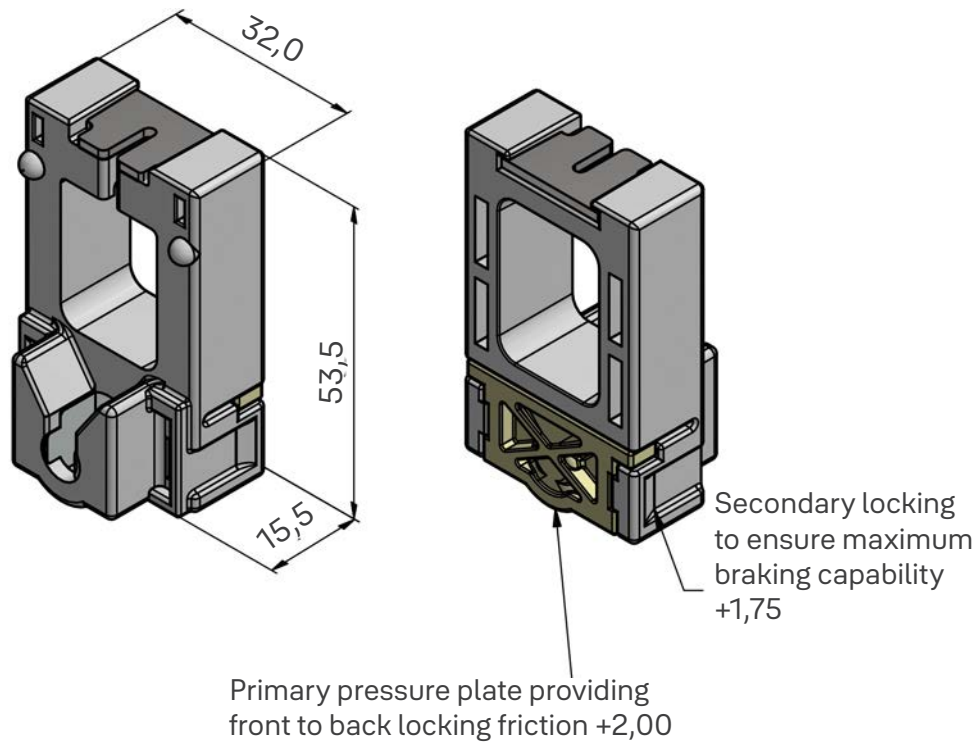

Cleverly designed to incorporate a 3-way braking system giving additional locking advantage over traditional designs

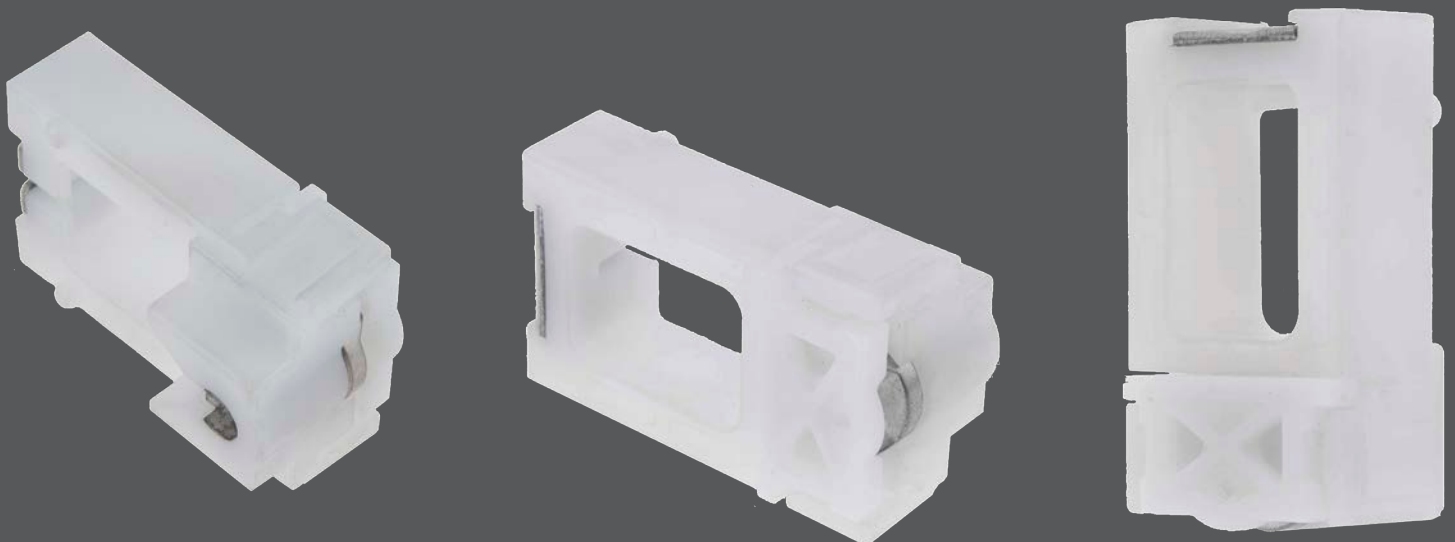

Colour
Variants
White

Packaging
Boxed in 100's

Material
Specification
Acetal
Nylon
ST 304
Zinc ZP3



Vertex™

Pivot Bar & Carrier

The Yale Vertex Pivot bar & pivot bar carriers offers both 'slide-off' and 'lift-off' functionality

- Horn and non horn options
- Works perfectly with Vertex Pivot Shoe
- Meets the requirements of BS EN 1670:2007
- Quick release 'slide-off' option
- Simple 'lift-off' option
- Manufactured totally from non-ferrous materials

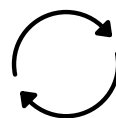

Cycle Tested to BS 6375:
Part 2 (20,000 cycles)

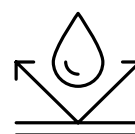

BS EN 1670: Grade 4
240 Hours NSST



**MANUFACTURERS
GUARANTEE**



Slide-off Pivot Bar Applications

	Upper Sash						Lower Sash	
Window System	Non Horn		Plant on Horn		Run Thro' Horn			
	Pivot Bar	Carrier	Pivot Bar	Carrier	Pivot Bar	Carrier	Pivot Bar	Carrier
VEKA	YVSPB01	YVSPBC01	YVSPB02	YVSPBC01	YVSPB02	YVSPBC01	YVSPB01	YVSPBC01
	<i>YVSPB01</i>	<i>YVSPBC02</i>	<i>YVSPB02</i>	<i>YVSPBC02</i>	<i>YVSPB02</i>	<i>YVSPB04</i>	<i>YVSPB01</i>	<i>YVSPBC02</i>

Lift-off Pivot Bar Applications

	Upper Sash						Lower Sash	
Window System	Non Horn		Plant on Horn		Run Thro' Horn			
	Pivot Bar	Carrier	Pivot Bar	Carrier	Pivot Bar	Carrier	Pivot Bar	Carrier
VEKA	YVSPB01	YVSPBC01	YVSPB02	YVSPBC01	YVSPB02	YVSPBC01	YVSPB01	YVSPBC01
	<i>YVSPB01</i>	<i>YVSPBC02</i>	<i>YVSPB02</i>	<i>YVSPBC02</i>	<i>YVSPB02</i>	<i>YVSPB04</i>	<i>YVSPB01</i>	<i>YVSPBC02</i>

1. All part codes marked * require the use of the spring loaded horn
2. All part codes in **bold text** are Yale's recommended hardware
3. All part codes in *italic text* are Yale approved alternatives
4. Several Pivot Bar and Pivot Bar Carriers can be used in both 'Slide-Off' and 'Lift-Off' applications

Maintenance

Yale Vertex Pivot Bars and Pivot Bar Carriers are maintenance free. Yale recommends this product is surface cleaned with a damp cloth only and is kept free from any building materials and debris which could affect the mechanism.

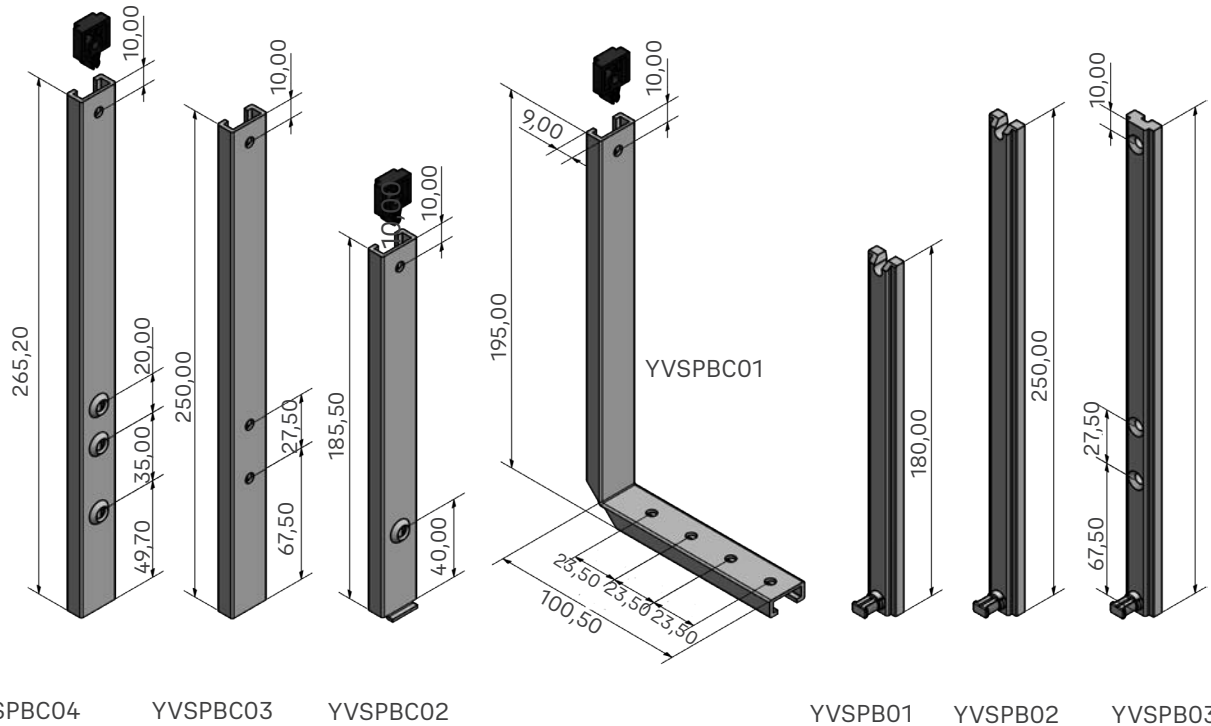

Lift Off Sash Removal Procedure

Step 1. Assess if lifting the sash to be removed safely is a one or two person operation. For sashes weighing more than 25kg or wider than 1,200 mm we strongly suggest two people are employed.

Step 2. Slide the sash to be removed vertically until the lower rail of the sash is as close to your midriff as possible.

Step 3. By releasing the Tilt Latches allow the sash to rotate until the Tilt-In Bar Restrictors are supporting the weight of the sash. If no Tilt-In Bar Restrictors are fitted follow Step 5 below.

Step 4. Release the Tilt-In Bar Restrictors whilst always supporting the weight of the sash

Step 5. Gently rotate the sash until it is horizontal (90°) fully supporting the weight of the sash at all times. Keeping the sash horizontal at all times the sash can now be lifted upwards until the Pivot Bar End Casting is above the Pivot Shoe and the sash can then be moved away from the window.

Re-installing the sash is a direct reversal of the steps above to remove it. Always ensure the sash is kept horizontal until both Pivot Bars are fully engaged in the Pivot Shoes. Re-connect any Tilt-In Bar Restrictors and then fully close the sash ensuring that the Tilt Latches have engaged into the window frame. Operate the sash a few times to ensure re-fitting has been successful.

Glide Off Sash Removal Procedure

Step 1. Assess if lifting the sash to be removed safely is a one or two person operation. For sashes weighing more than 25kg or wider than 1,200 mm we strongly suggest two people are used.

Step 2. Slide the sash to be removed vertically until the lower rail of the sash is as close to your midriff as possible.

Step 3. By releasing the Tilt Latches allow the sash to rotate until the Tilt-In Bar Restrictors are supporting the weight of the sash. If no Tilt-In Bar Restrictors are fitted follow Step 5 below.

Step 4. Release the Tilt-In Bar Restrictors whilst always supporting the weight of the sash.

Step 5. Gently rotate the sash until it is horizontal (90°) fully supporting the weight of the sash at all times. Keeping the sash horizontal at all times the sash can now be pulled inward. Initially with a sharp tug to release the Carrier Clip Moulding from the Pivot Bar and then sliding the Sash complete with the Pivot Bar Carriers attached away from the window leaving the Pivot Bars retained in the Pivot Shoes. Do not handle the Pivot Bars at any time with the sash removed as this could release the Pivot Shoes braking system and they will move rapidly with a risk of injuring anyone close by.

Re-installing the sash is a direct reversal of the steps above to remove it. Always ensure the sash is kept horizontal and fully supported until both Pivot Bars Carriers are fully slid home on to the Pivot Bars which will require ensuring that the Carrier Clip Moulding is fully engaged in the Pivot Bars. Re-connect any Tilt-In Bar Restrictors and then fully close the sash ensuring that the Tilt Latches have engaged into the window frame. Operate the sash a few times to ensure re-fitting has been successful.

Pivot Bar
End casting

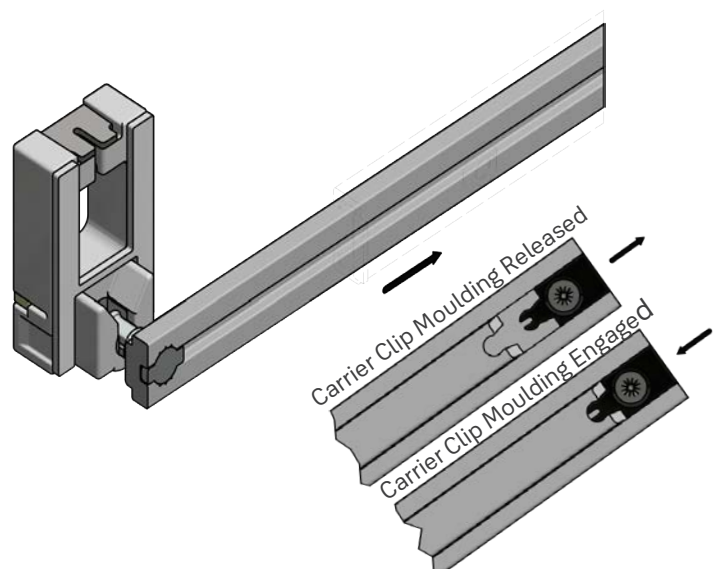
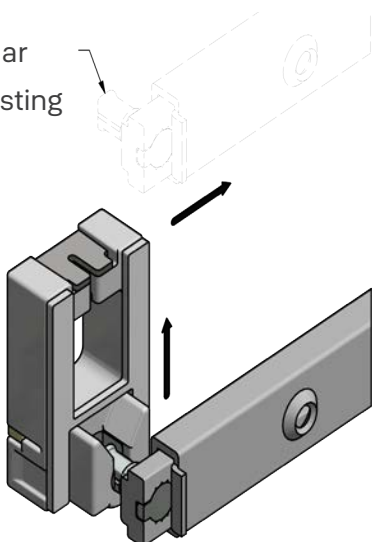

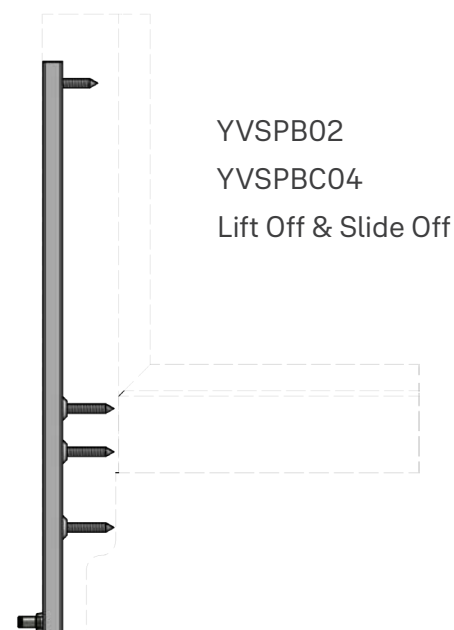
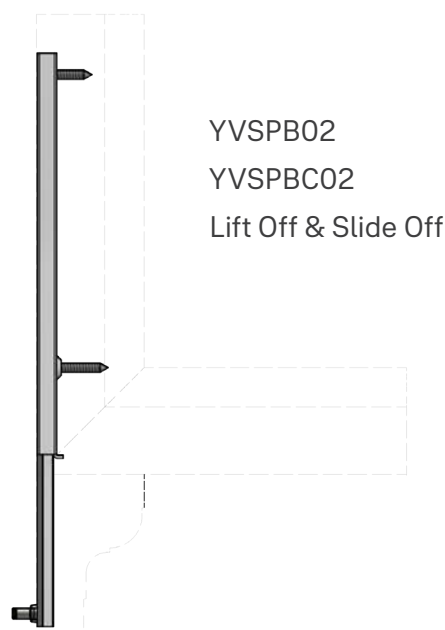
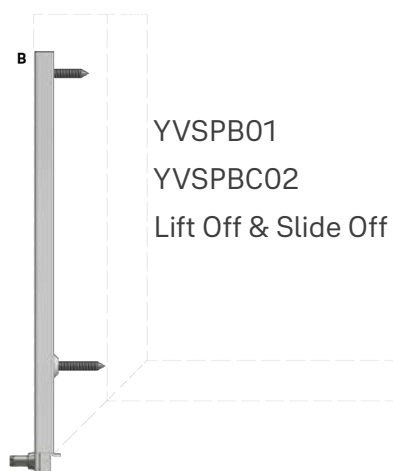
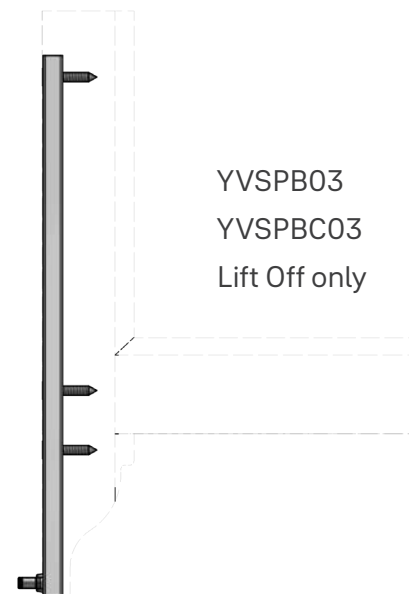
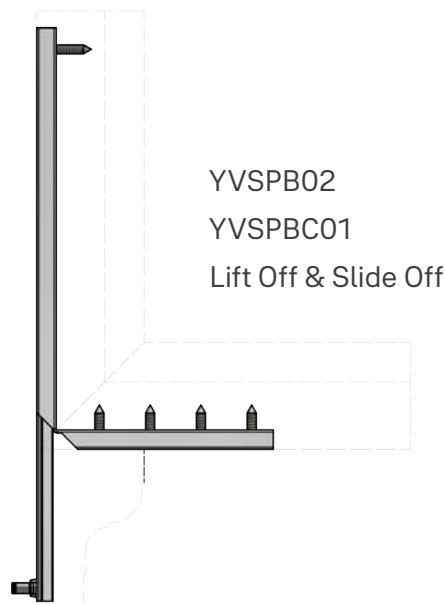
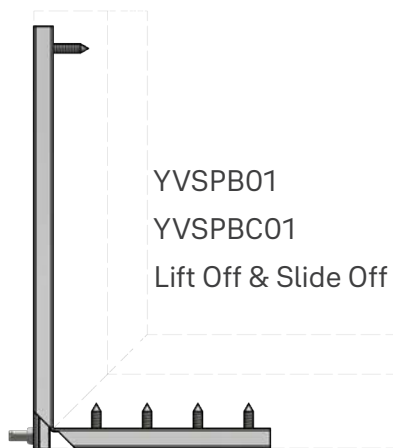

Typical applications

1. See chart on Page 2 for specific window system details
2. All sash corners are dressed clean to ensure Pivot Bar Carriers fit correctly
3. Required gap between sash and frame is 2.5mm - 3.5mm

Important: When using as 'slide off' Pivot Bars do not turn the pivot bars when the sash is removed, doing so may release the pivot shoe brake causing the spring balances to retract at speed

Maintenance

Yale Vertex Pivot Bars and Pivot Bar Carriers are maintenance free. Yale recommends this product is surface cleaned with a damp cloth only and is kept free from any building materials and debris which could affect the mechanism.

Packaging

Pivot Bars Boxed in 100's
Pivot Bar Carriers (Including carrier clip moulding where applicable)
Boxed in 100's

Material Specification

Aluminium 6082T6
Reinforced Nylon



Vertex™

Tilt Restrictors

Perfectly engineered allowing users to choose between tilt modes to make cleaning and maintenance more convenient

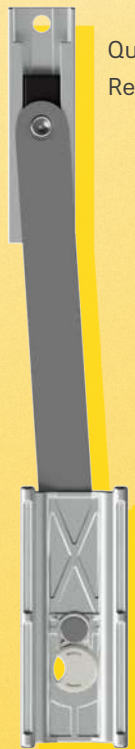

Quick Release Tilt Restrictor

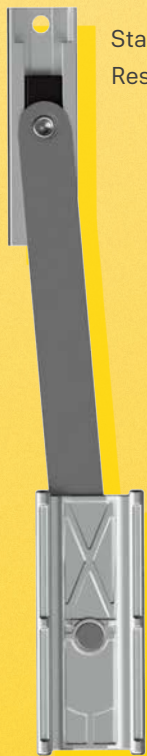

Standard Tilt Restrictor

- Yale branded hardware
- Constructed in high quality materials
- Included with the Yale Lifetime Security Guarantee
- Standard and quick release models available
- A size range to suit almost any window
- Suitable for sashes weighing up to 35kgs
- Suitable for Sashes between 315-1200mm tall
- Enables cleaning of external faces of sliding sashes

**10
YEAR**
**MANUFACTURERS
GUARANTEE**



BS EN 1670:2007 Grade 4

(240 Hours NSST)



Product	Part code
Tilt Restrictor 150mm - Standard	YVSTR150
Tilt Restrictor 250mm - Standard	YVSTR250
Tilt Restrictor 350mm - Standard	YVSTR350
Tilt Restrictor 150mm - Quick Release	YVSTRQ150
Tilt Restrictor 250mm - Quick Release	YVSTRQ250
Tilt Restrictor 350mm -Quick Release	YVSTRQ350

Maintenance

The Vertex range of Tilt Restrictors are maintenance free. Where required surface cleaned with a damp cloth only and avoid using abrasive cleaning products. Please ensure the sash is free from any building materials and debris which could affect the mechanism.

Sash without sash spacer

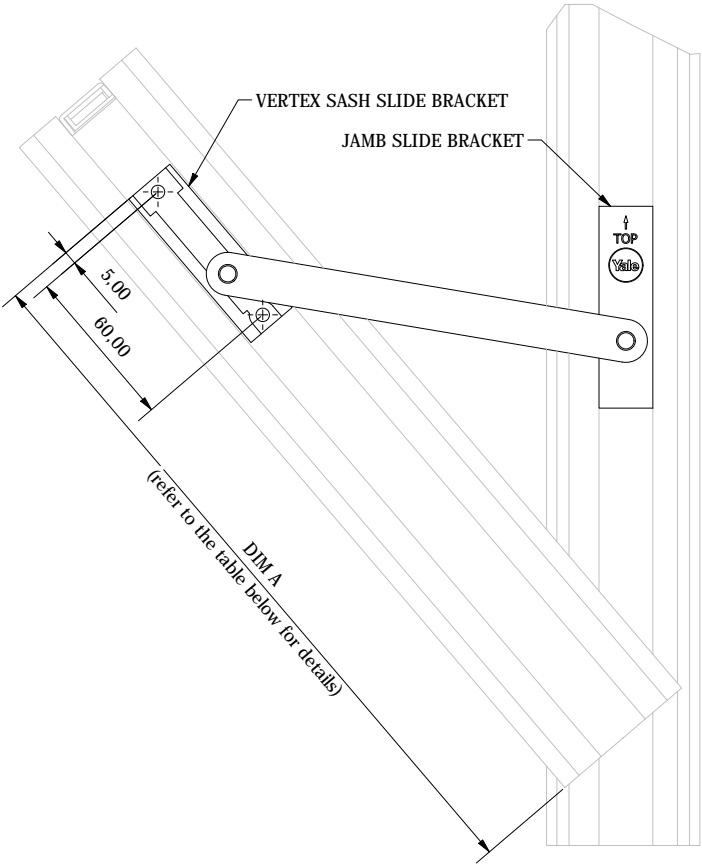

Sash with sash spacer

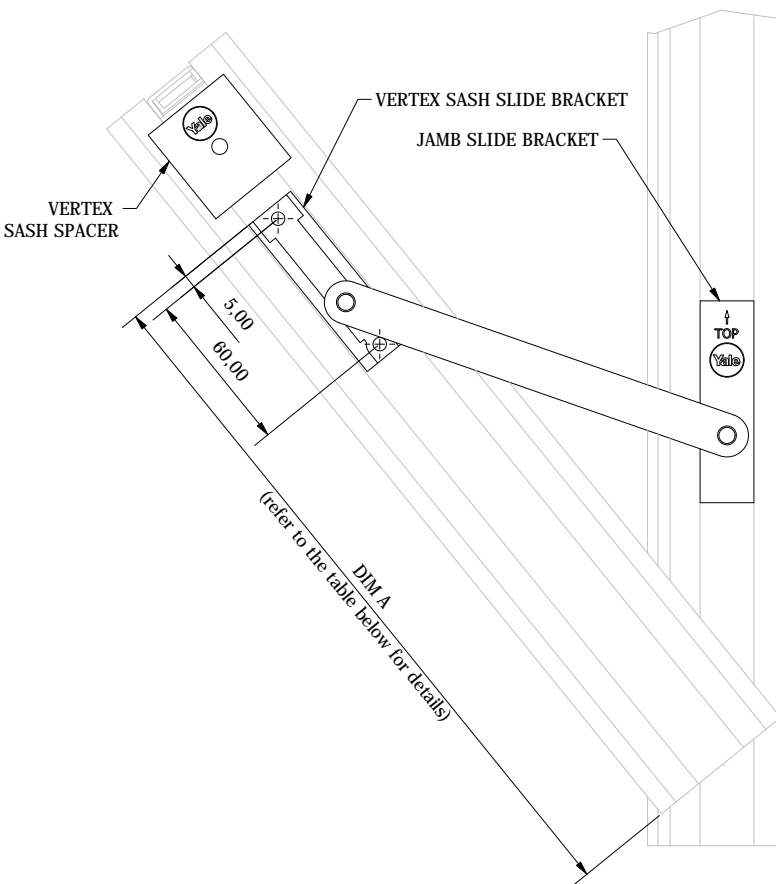

Sash Height	Restrictor Size	Dim 'A'	
		Without sash spacer	With sash spacer
Min 315mm Max 450mm	150	268mm	252mm
Min 451mm Max 650mm	250	395mm	352mm
Min 651mm Max 1200mm	350	495mm	452mm

- See page 2 for system specific part code
- Dim 'A' applies to both Vertex Standard and Vertex Quick Release Tilt Restrictors
- Dim 'A' is for the complete sash height and should include the horn, if applicable. If spring loaded horns are fitted to the sash then DIM 'A' applies only to the sash height and excludes the horn
- Two Vertex Tilt Restrictors must be fitted to each tilt in sash (one each side) to achieve the sash height and sash weight performance quoted in this document and provide user safety
- Vertex Tilt Restrictors are designed for sash heights from 315mm to 1,200mm

- All Vertex Tilt Restrictors are suitable for sashes weighing up to 35.0kg
- A gap between sash and frame of between 2.5mm and 3.5mm on both sides is required for Tilt Restrictors to function correctly
- The Vertex Standard and Quick-Release Tilt Restrictors require the Jamb Slide Bracket to be fitted into the Window Frame Jambs either before frame welding or preferably via a machined access concealed behind the travel stops
- Standard Tilt Restrictors can be engaged and released via the Sash Slide Bracket (details on page 4) ensure access is possible post window installation
- Quick Release Tilt Restrictors can be engaged and released via the Quick Release Jamb Moulding (details on page 4) Ideal for deep reveal applications
- At anytime when the Tilt Restrictors are disengaged the window sash must be fully supported to prevent injury and potential damage to window and installation
- Vertex Tilt Restrictors are intended to support the weight of the sliding sash and enable cleaning of the external face of the slide sash

Standard Tilt Restrictor Release

Fixing Detail

Use Ø4.8 (No.10) Pan head screw ensuring full engagement into profile reinforcement

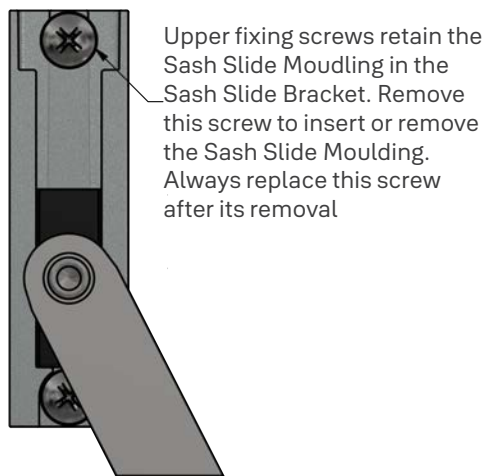

After removal of the upper fixing Screw the window sash should be gently pushed towards the vertical and the Sash Slide Bracket Moulding can be removed from the Sash Slide Bracket on both sides. The window sash is no longer restricted and must be fully support at all times until the Sash Slide Mouldings are re-engaged and secured in the Sash Slide Brackets

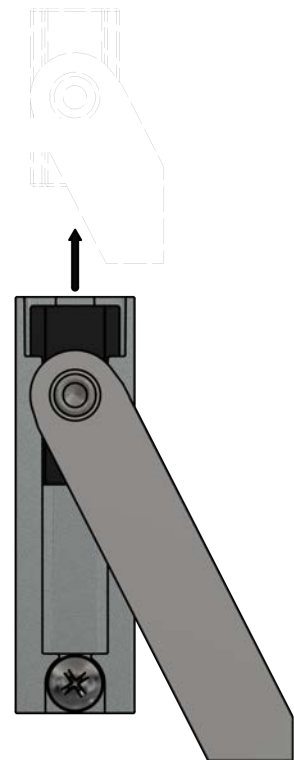

Quick Release Tilt Restrictor Release

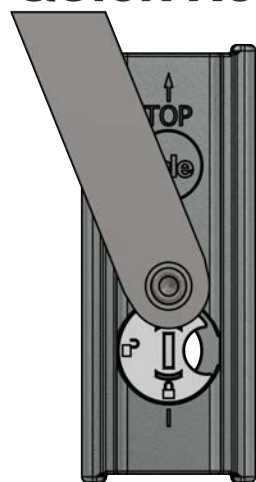

Quick Release Jamb Slide Moulding shown in the 'locked' position and the Tilt-In Bar fully retained

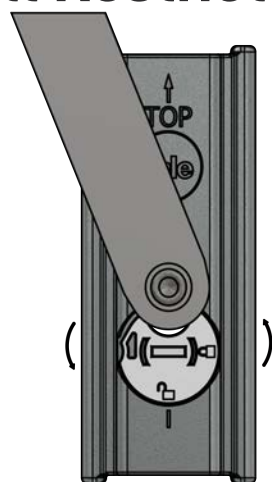

Quick Release Jamb Slide Moulding rotated to the 'unlocked' position using a flat ended screwdriver. Once completed on both sides the Tilt-In Bars can now be removed from the moulding by extracting the rivet head through the now enlarged access hole and lifting the Jamb Slide slightly as necessary. Whilst doing this process remember that the sash is no longer restricted and must be fully supported by the user at all times to prevent injury and potential damage to window and installation.

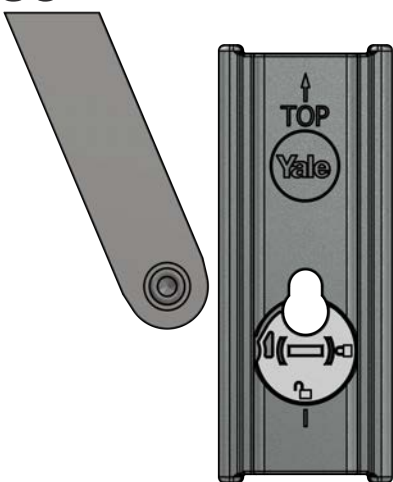

The Tilt Restrictor shown released. To re-install the Tilt Restrictor first re-fit the round rivet end into the larger diameter formed by the Jamb slide Moulding. Then push the Jamb Slide Bracket downwards enabling the Quick Release Jamb Slide Moulding to be rotated 90° anti-clockwise, again using the flat ended screw driver, to fully retain the Tilt Restrictor in position. Complete this operation on both sides of the sash, the sash can now be rested on the Vertex Quick Release Tilt Restrictors again.

Packaging

Standard Restrictors Boxed in 100's
Quick Release Restrictors Boxed in 100's

Material Specification

Stainless Steel
Reinforced Nylon
High-Performance Zinc
Acetal Resin



Vertex™

Sash Spacer

Bespoke sash slide and sash security accessories

- Essential for PAS24 security test requirements
- Purpose designed for optimum performance
- Rugged and durable product
- Yale Branded Hardware
- Included within the Yale Lifetime Security Guarantee



Material Specification

Reinforced Nylon

Packaging

Boxed in 100's

Colour Variants

White

Technical Specifications



Product	Profile Sytem	Part code
Sash Spacer - White	VEKA	YVSSS02-WH

Maintenance

Yale recommends this product is surface cleaned with a damp cloth only and is kept free from any building materials and debris which could affect the mechanism.

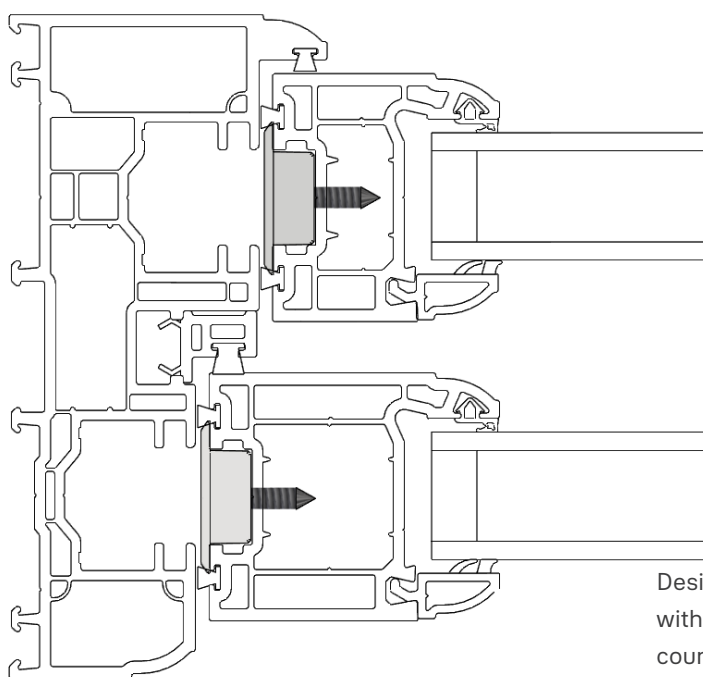

Designed for use
with a Ø4.8mm
countersink screw

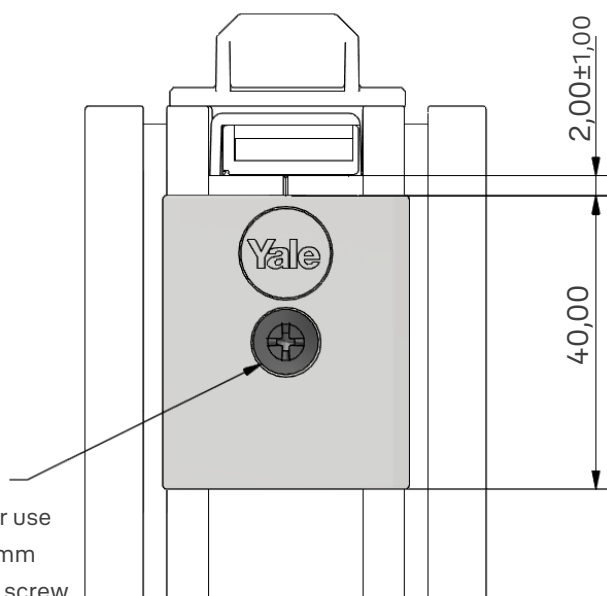



Vertex™

Tilt Latches

An engineered product offering excellent functionality and security.

- Designed for uPVC, Timber and Aluminium windows
- Compatible with a wide range of window systems
- Suitable for Security Applications
- Included within the Yale Lifetime Security Guarantee
- Available in a range of colours
- Suitable for push to lock applications
- Manufactured from high performance materials
- Designed to achieve the security requirements of PAS24

Handed 'Push to lock' Tilt Latches

(Tilt latch finials sold separately)

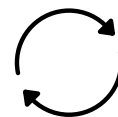

Cycle Tested to BS 6375:
Part 2 (20,000 cycles)

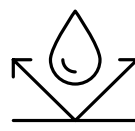

BS EN 1670: Grade 4
240 Hours NSST



PAS24

Designed to achieve the requirements
of PAS24 when fitted with Yale's
complete Vertex hardware

**10
YEAR**
**MANUFACTURERS
GUARANTEE**



Product	Part code
Tilt Latch RH - White	YVSTL01RH-WH
Tilt Latch LH - White	YVSTL01LH-WH
Tilt Latch RH - Grey	YVSTL01RH-GRY
Tilt Latch LH - Grey	YVSTL01LH-GRY
Tilt Latch RH - Black	YVSTL01RH-BK
Tilt Latch LH - Black	YNSTL01LH-BK

Tilt latch and heritage tilt finial

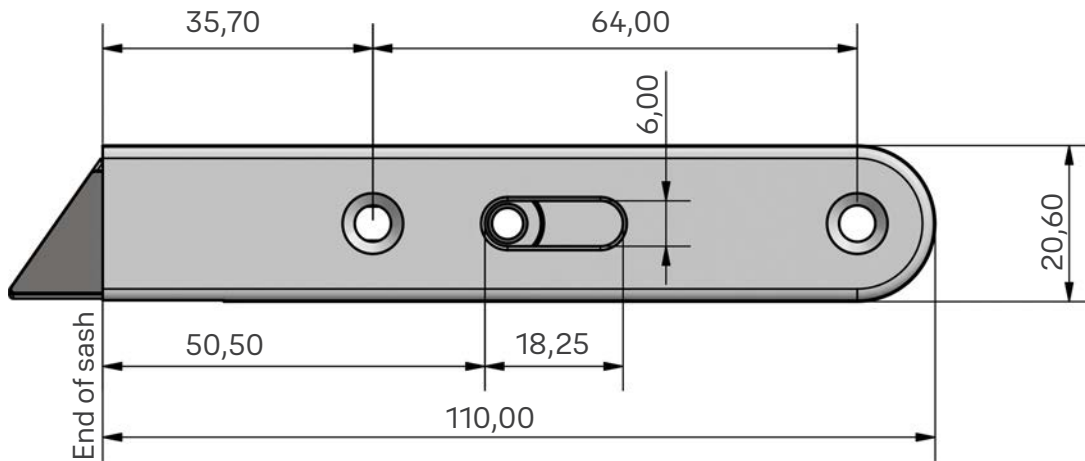

Fixing screw needs to be long enough to enageg in the profile reinforcement - Ø4.8 countersink screws recommended

Upper sash hole position for Tilt Latch

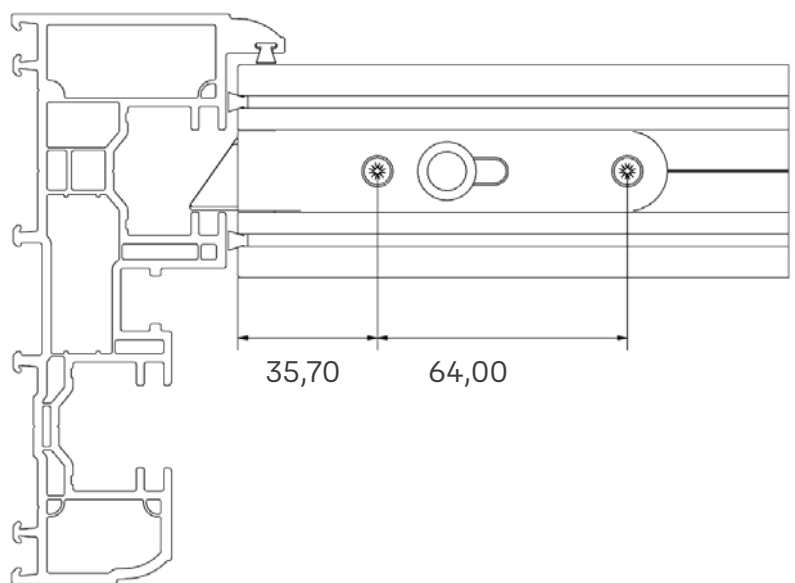

Slot position on lower sash interlock for Tilt Latch

(fixing holes as upper sash)

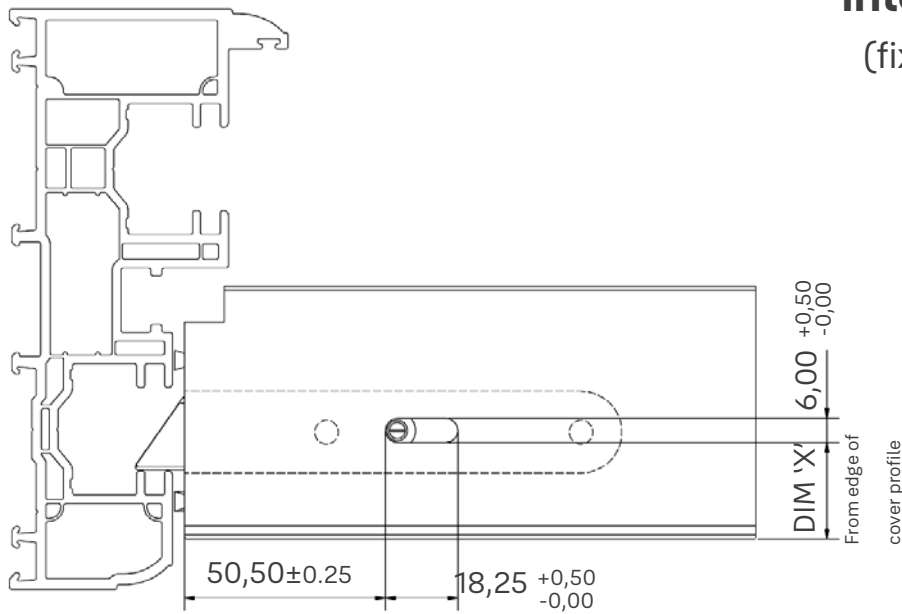

Window System

DIM 'X'

Veka

23.25

Upper sash non-decorative Tilt Finial

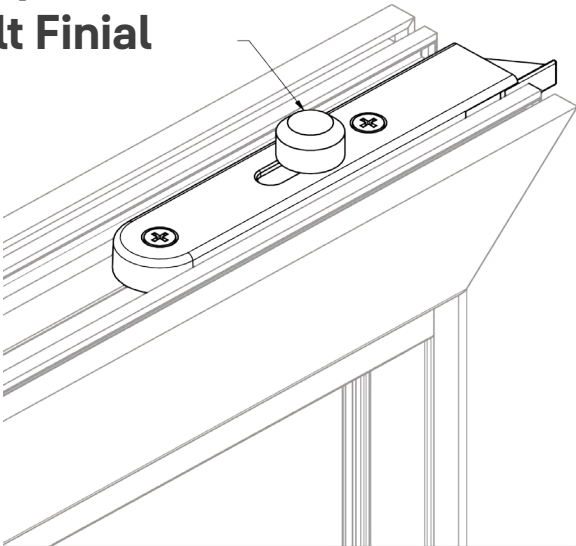

Lower sash contemporary Tilt Finial

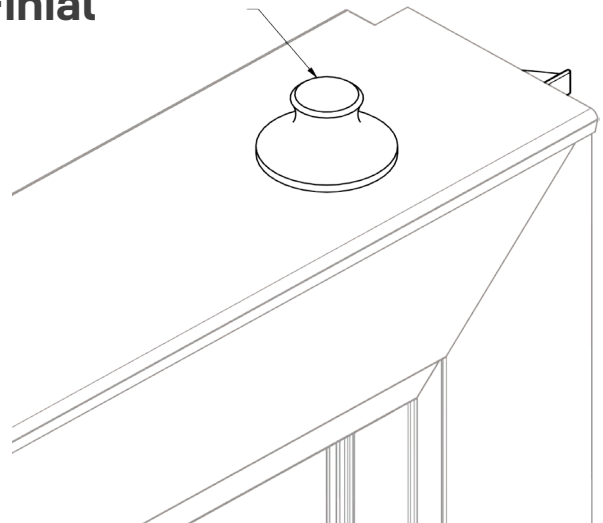

Maintenance

Yale recommends this product is surface cleaned with a damp cloth only and is kept free from any building materials and debris which could affect the mechanism.

Colour Variants

White
Black
Grey

Packaging

Boxed in 100's

Material Specification

Stainless Steel 304
Reinforced Nylon
High performance Spring Steel



Due to a continuous programme of development the company reserves the right to make alterations without notice. (Products which are not a stocked item will be subject to a longer lead time which needs to be agreed with your Yale representative)

Part of ASSA ABLOY

© ASSA ABLOY

December 2023

V1.0

Yale DWS

School Street, Willenhall, West Midlands

WV13 3PW, UK

T: 01902 366800 F: 01902 369041

www.yaledws.co.uk