

Fitting guide

To reduce the risk of theft it is essential that your safe is securely fixed. Please use the bolts provided and secure to a solid floor.

For maximum performance and correct installation a professional locksmith must install the safe.

Before operating your new Yale safe, please read the user manual.

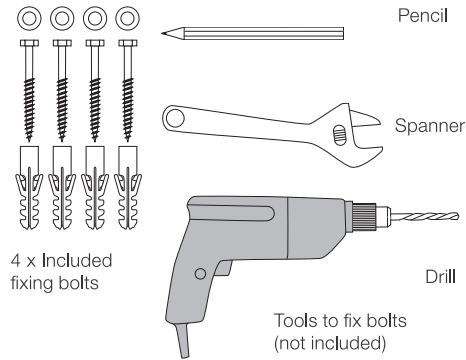

! The performance of the safe is dependant on the quality of the installation and the quality of material to which the safe is fixed.

! This product is heavy. Incorrect installation may result in injury.

Before fixing the safe please ensure :

- That the safe is placed horizontally,
- That the safe in a dry environment to prevent corrosion to the safe and locking mechanism.
- That the fixing bolts provided for installation on a solid floor.

1 Mark the position of the safe through fixing holes.

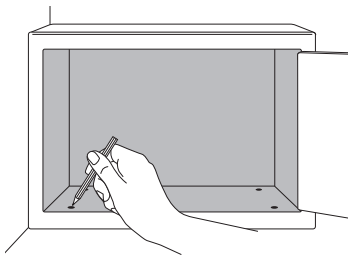

3 Reposition the safe over the holes. Drop the screws and washers through the safe into the drilled holes.

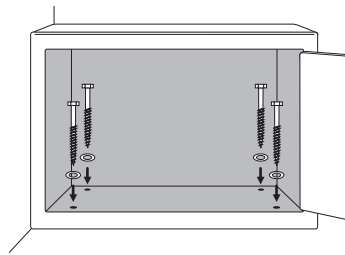

2 Remove the safe and drill the holes as marked. If needed, drop the plugs in the drilled holes.

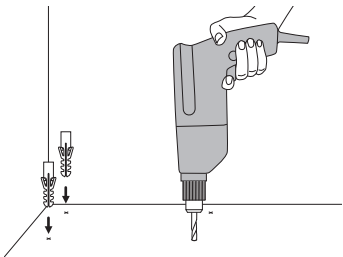

4 Tighten the fixing bolts firmly and ensure there is no movement of the safe.

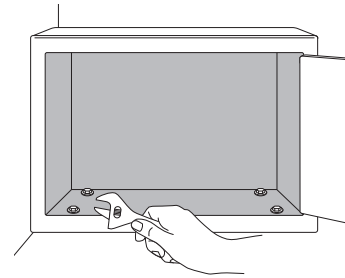

ASSA ABLOY
School Street, Willenhall, West Midlands WV133PW
Tel: UK: 01902 364606 Tel: ROI: 1890 927622
www.yale.co.uk



Treasuring your freedom.

Yale Safe User Manual

For models:

YSV/200/DB1

YSV/250/DB1

YSV/390/DB1

YLV/200/DB1

Please keep manual safe for future reference.

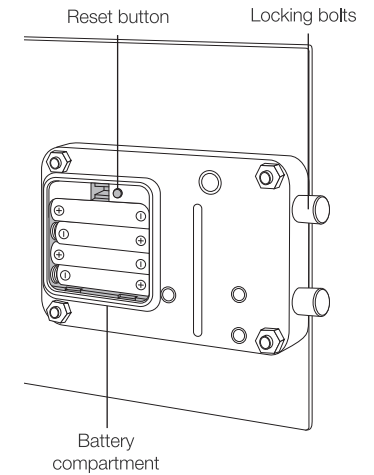
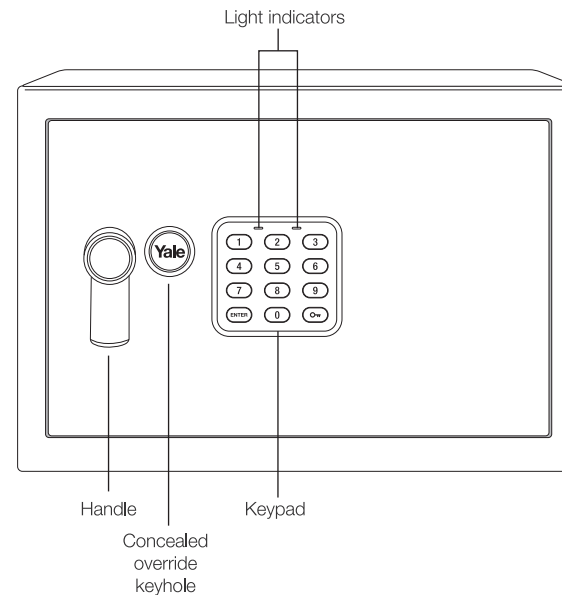

An ASSA ABLOY Group brand **ASSA ABLOY**

The world's favorite lock



Installing/Replacing the batteries

Before using your Yale safe you must insert batteries. The safe requires 4 "AA" (1.5V R06) – batteries.
When batteries need changing t

Opening the safe

2

-
- 1 Enter your user code and press .
 - 2 If the code is correct, you will hear a confirmation sound, the green light will illuminate. Turn the handle counterclockwise and open the door.

Set/re-set your user code

