

Mix and match

With a range of colour options available, Postmaster Professional can now be ordered in a unique combination of finishes to complement the internal and external hardware.

Colour options: white, black, chrome, satin silver, polished gold or brushed silver effect.

External



White



Black



Chrome



Satin Silver



Polished Gold



Brushed Silver Effect

Internal



White



Black



Chrome



Satin Silver



Polished Gold



Brushed Silver Effect

Material Specification

External flap: Austenitic 304 stainless steel
Internal flap: Aluminium

Packaging

10 letterplates per box, boxed in 1's

Maintenance

Yale recommends that all moving components are lubricated using a non-acidic mineral oil at least twice a year and surface cleaned with a damp cloth. The product may need to be adjusted to ensure satisfactory operation.



TS008:2015 Accredited

Enhanced security and general requirements for letterplate assemblies and slide through boxes



10 Year Mechanical Guarantee

Delivering peace of mind from the world's favourite lock company with our fantastic 10 year mechanical guarantee



25 Year Surface Finish Guarantee

All our products are designed to withstand all types of weather conditions with anti-corrosion coatings; ensuring high performance all year round



PAS24:2016 Compliant

Proud to comply with PAS 24:2016, this standard ensures our products provide enhanced security performance and resist attack tests giving our customers piece of mind



Document Q Compliant

Compliant with Document Q; our windows and doors are designed to withstand unauthorised access and resist forceful attack methods with robust design and appropriate hardware

THE YALE BRAND, with its unparalleled global reach and range of products, reassures more people in more countries than any other consumer locking solution.

THE ASSA ABLOY GROUP is the world's leading manufacturer and supplier of locking solutions, dedicated to satisfying end-user needs for security, safety and convenience.

© Yale, September 2018

Yale

School Street, Willenhall, West Midlands WV13 3PW, UK
T: 01902 366800 F: 01902 369041
www.yaledws.co.uk

Due to a continuous programme of development the company reserves the right to make alterations without notice. (Products which are not a stocked item will be subject to a longer lead time which needs to be agreed with your Yale representative).

*Technical Specification TS008:2015/ DHF1112:04/16

Postmaster Professional

The highly secure, TS008-accredited letterplate from Yale



- Patent pending design to complement a variety of applications
- Designed to combat common attack methods such as 'fishing'
- TS008:2015 accredited
- Conforms to the requirements of PAS24:2016 and Approved Document Q
- 25 year surface finish guarantee

Helping you stay compliant with the new standards

Your key to PAS24:2016 compliance

All new Secured by Design applications on or after 1st October 2018 will be required to have door sets that are fully certified to PAS24:2016 (Enhanced security performance requirements for door sets and windows in the UK). The updated PAS24:2016 standard references the Door and Hardware Federation (DHF) TS008:2015 security standard. This means that to meet the latest requirement the door will require a TS008 accredited letterplate to comply.

TS008 letterplates are referenced within the Building Regulations Approved Document Q as being shown to protect against various attack methods, including letterplate 'fishing'.

What is 'fishing'?

Fishing is a common method of attack whereby items such as keys are removed from the home via the letterplate.

TS008 explained

This technical specification provides a means of evolution against opportunist attack and to prevent contents from being removed from the property. It applies to all letterplate assemblies that allow mail to pass directly through a door or side panel and all slide through boxes that allow mail to pass directly through a door or door side panel.*

The Yale Postmaster Professional TS008 letterplate boasts a long list of features that set it apart from the other letterplate options. With its 96mm sightline height, and telescopic feature allowing it to suit a range of door types and thicknesses, this letterplate offers the utmost practicality and versatility.

Designed with security in mind, the inner flap has a positive stop feature to guard against common attack methods and 'fishing'.

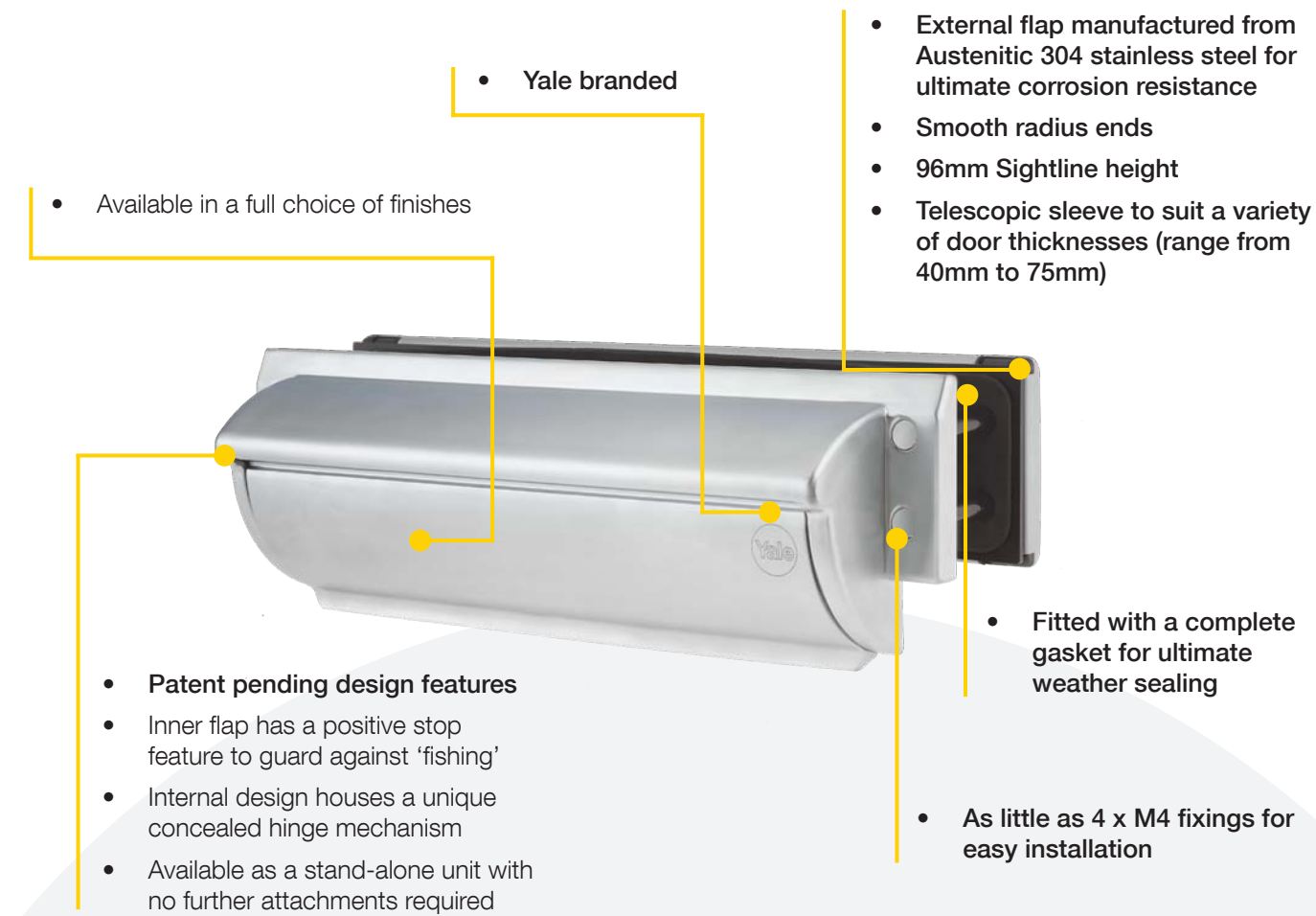

Specification

- TS008:2015 accredited
- Conforms to the requirements of PAS24:2016 and Approved Document Q
- Can be fitted to any PVC, timber or composite door for TS008:2015 compliance
- External unit corrosion tested to BS EN 1670 Grade 5—*tested in excess of 1000 hours NSST*
- Tested to 20,000 cycles
- 10 year mechanical guarantee
- 25 year surface finish guarantee
- **Classification: A12N3N00**

Technical illustrations

Profile

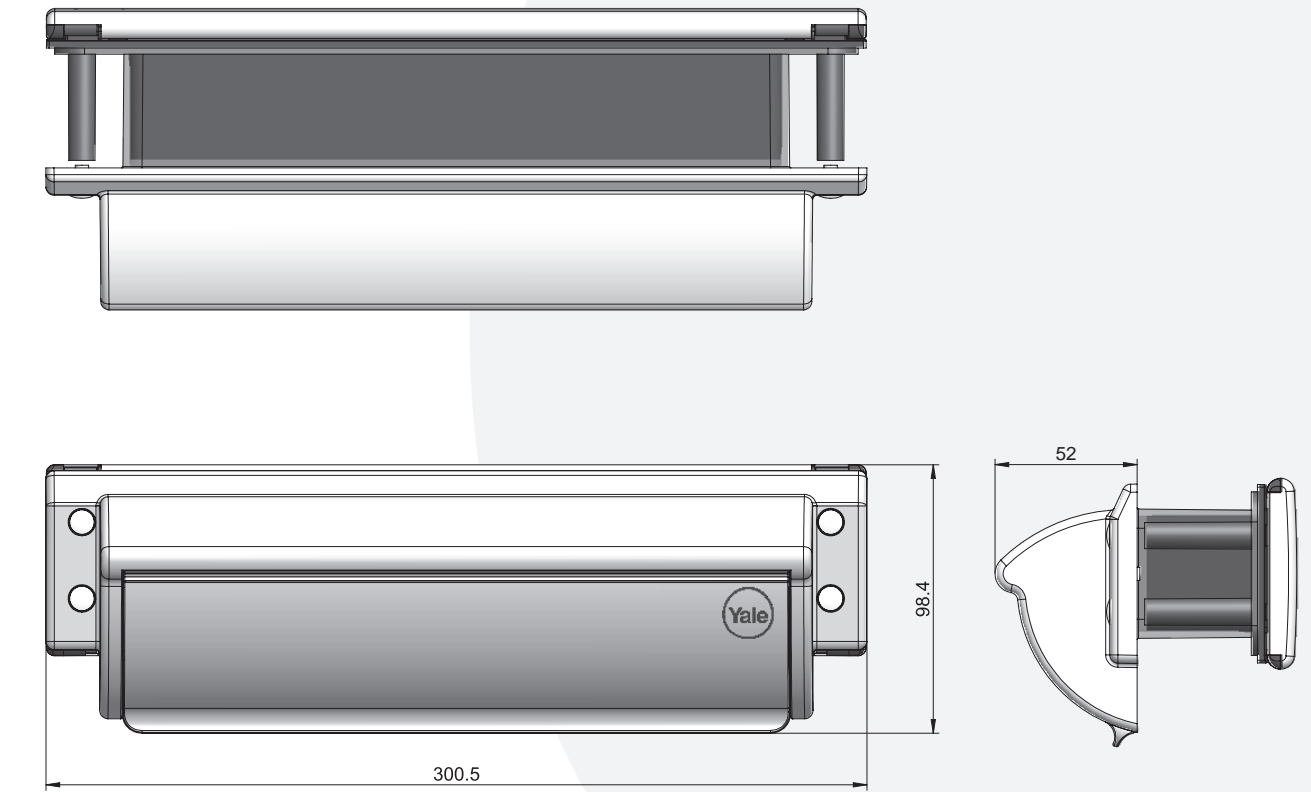

Routing

